

SECTION 1 - Applicant Information

Name of Organisation WICKEPIN COMMUNITY SHED
 Postal Address 518 RUSSELL RD.
 Contact Person JENNY HEMLEY
 Position SECRETARY
 Telephone 4888 1041
 Email jennyhemley@bigpond.com

Is your organisation a Not for Profit body? Yes No

Is your organisation an Incorporated body? Yes No

If yes Incorporation Number? _____

Is your organisation registered for GST? Yes No

Australian Business Number (ABN) 93 242 265 501

Does your organisation have a constitution? Yes No

Financial information

Please attach a copy of the audited financial statement for the last financial year.

Previous assistance from the Shire of Wickepin

Has council previously assisted your organisation? Yes No

Date of last grant (if known)? 2019.

Amount of last grant: \$ 700-00

Application Summary

Project title CLOSE IN HALF OF SECOND SHED

Total project funds requested \$ 1740

SECTION 2 - General Information about your organisation and services provided

This section is designed to help you provide information that will give some general background about your organisation, the service it provides and the reasons for your request to council.

What are the main purposes of your organisation?

Our main purpose is to provide a safe, happy and encouraging environment for people to come together, repair and work on projects for the community and themselves. To help those with health issues by talking openly. There is a relaxed and happy atmosphere in the Shed and for some it is their weekly social outing.

What are the main services it provides?

Our members have skills that are called on by the community and sporting groups which benefit all. We also hold workshops during the year for those interested to help with new and old skills. Our main focus is sculptures for the Heritage Walk Trial.

Describe how your organisation operates ie: by volunteers, paid staff, combination of both. Please indicate how many staff and volunteers you have.

Our organisation is operated by volunteers of which there are 17 regular members.

If not clearly specified in your financial statements, describe your main funding sources eg: government grants (please state source), fundraising, members fees, fees for services, etc.

The Sheds main source of funding is through market day sales of pieced made by members and member fees. We also do paid tasks which we have completed for community projects.

Approximately how many people are members of your organisation or how many community members benefit from the services provided by your organisation? Please describe any eligibility requirements for membership or access to services.

There is no eligibility to access serviced at the Shed although children under 14 must be accompanied by an adult. We have 30 registered members. Workshops have attracted participants from surrounding Shires.

From where does your organisation or service operate?

RICHTER STREET, WICKEPIN

If you are requesting a grant for capital works for a building, please indicate who owns the premises? A letter of support is required from the owner of the building. Will the project require a building permit? Yes No

Who owns the land on which your facility is or will be located?

SHIRE OF WICKEPIN

Annual rent paid for use of premises? \$ _____

What geographical areas does your organisation cover?

- Shire of Wickepin area only?
- Shire of Wickepin area and adjoining areas?

SECTION 3 – Project Details

What is the funding to be used for?

- Purchasing goods and services such as sporting equipment or materials or engaging professionals for the purpose of instruction.
- Infrastructure such as significant construction or improvement of facilities. (Please include building and planning approvals if required.)
- Funding for specific events or programs.
- In kind assistance (venue/bus hire etc). Separate letter of request addressed to CEO will be required.

Which of the Shire of Wickepin’s Strategic Goal themes does your project align with?

- To develop and maintain quality services and infrastructure.
- To ensure the protection and improvement of the environment.
- To promote the development of a viable and diversified local economy.
- To provide and encourage the use of a variety of recreational, educational and cultural facilities.
- To provide efficient, effective and accountable governance.
- To promote the Shire as the focal point in the development of the greater region.

How?

To move the wood working equipment to a safer area which would be encouraging for more members, where there would be more room, reduce noise levels in the present shed which includes the metal work side and safety. If closed in everything would be locked away safely.

Project Description

Attach photos, plans or diagrams to illustrate your request if relevant.

To enclose the shed with Zinalum which will have two sliding doors. It has become evident that more members wish to improve their wood working skills and some are in the process of doing up an old wagon which needs to be done under cover.

Start Date: AUGUST 2020

Finish Date: DECEMBER 2020

Would it be possible to share with another group? (ie is your proposal duplicating an existing service?)

Yes No

If yes – please comment.

Demonstrate how you have the full support of your members and the general community for your funding application. Attach minutes of meeting where project funding was discussed and approved. Provide letters of support.

Section 4 - Project Cost

Council's general philosophy is to fund only the following

- 100% up to \$2000
- 75% between \$2,000 and \$5,000
- 50% \$5,000 and above

Voluntary labour and equipment may be included in the applicant's contribution at a value of \$25 per hour. Council employees or equipment may be used in lieu of a cash contribution from Council. Council will favour applications that would not otherwise be funded through other government grants eg: Department of Sport and recreation CSRFF Grants.

Please complete the table below, showing income and expenses from all sources including in-kind, donated materials or voluntary labour (\$25/hr).

Income			Expenditure		
Source	Cost/Description	Amount (ex GST)	Supplier	Description/Quantity	Amount (ex GST)
<i>E.g. Lotterywest Shire of Wickepin</i>	<i>E.g. In Kind Labor Grant</i>	\$2000	<i>E.g. Ewen's Rural</i>	<i>Cement and Posts</i>	\$2100
SHIRE OF WICKEDIN	GRANT	\$1650.00			
TOTAL INCOME Exc GST: \$			TOTAL EXPENDITURE Exc GST:\$		
NB: If your organisation is not registered for GST, please ensure you request the whole amount inclusive of GST.					
TOTAL INCOME INC GST: \$ 1740.00			TOTAL EXPENDITURE INC GST: \$		

Please provide any other information relevant to your application.

SECTION 5 – Authorisation/Declaration

The authorised person signing this application should be an executive member of your organisation, ie President, Vice-President, Secretary or Treasurer.

I certify that I am authorised to submit this application on behalf of the organisation. I also declare that I have read the Shire of Wickepin Financial Assistance Guidelines and will comply with the provisions of the Shire of Wickepin Policy regarding the Community Assistance Grant Scheme.

Name: Jenny Hemley
Signature: Jenny Hemley
Position in Organisation: SECRETARY
Date: _____

Bank Account Name: WICKEPIN COMMUNITY SHED

Bank Number:	Account
0 6 6 - 6 5 2	1 2 1 6 3 2 9 9 5
BSB Number	Account Number

Please return your application to:
Shire of Wickepin
PO Box 19 WICKEPIN WA 6370

Please ensure you have included these items with your application:

- Financial accounts
- Detailed budget with supporting quotes
- Working drawings where applicable
- Letters of support
- Planning application
- Building application

MINUTES OF MEETING 13 May – 2020

Meeting via Email

Those who responded to earlier email sent out regarding costs to enclose half of second shed.

Dave Astbury, Jenny Hemley, Rex Bergin, Fiona Hastie, Carol McDougall, Chris Moore, Bob Porter, John Sutton, Phil Watson, Tom Sands.

All agreed with costs for grant to enclose half of the second shed.

Jenny Hemley

Secretary

Proposal to enclose existing Shed

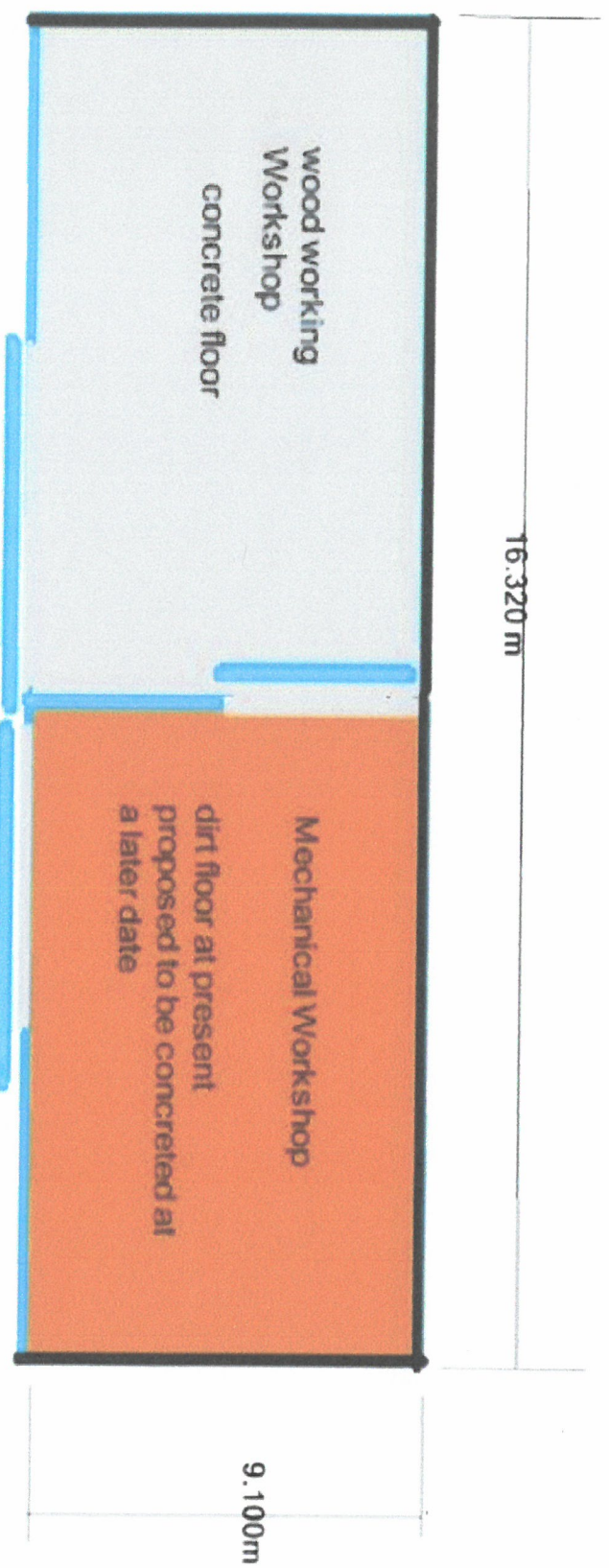

Key

- Existing Structures
- Walls
- Sliding Doors
- Concrete floors

- Additions to Existing Structure
- Walls
- Sliding Doors

- Trimdeck
- Colour None
- Length 3070mm
- Qty of sheets 36
- Fixing screws 1 box (1000) 12g x 20mm

Note
Not To Scale



Ewen Rural Supplies

38 Wogolin Rd Wickepin WA 6370

Ph 9888 1002 Fax 9888 1105 ewenrural@ewenruralsupplies.com

23rd April 2020

Jenny Hemley
Member SheShed/HeShed
518 Ruseell Road
Wickepin WA 6370

Dear Jenny

I support the SheShed/HeShed application to close in half of the second shed to be used for wood working purposes.

The members of the shed do many activities and workshops locally and have become an integral group within the community.

The application will enable them to keep performing all the wonderful projects they take on and enhancing the productivity of the Wickepin Shire by bringing people into the town to not only look at their works but to partake in all they offer.

Yours sincerely

Jayden Ewen

WICKEPIN COMMUNITY SHED

Financial Status as at 22 April 2020

Opening Balance as at 01/07/2019	\$ 876.75
Incoming	\$9433.71
Outgoing	\$5271.63
Balance as at 22 April 2020	\$5185.07

:



22 MAY 2020

Ewen Rural Supplies

38 Wogolin Rd Wickepin WA 6370

Ph 9888 1002 Fax 9888 1105 ewenrural@ewenruralsupplies.com

Hi Jenny,

Thanks for allowing us to quote on your steel for the Wickepin Mens Shed. Please see below our Quote.

100 0.42 BMT ZINCALUME TRIMDEK 96.120 M 322 8.00 M

(COVER 762MM WIDE)

Our material Id: 999849

Colour Zincalume

Quantity 24.000 Length 4,450 mm

Quantity 12.000 Length 3,560 mm

1 x Box of tek screws 12mm x 20mm

Total delivery weight 322.271

Price \$1680

Delivery and Freight 60.00

TOTAL PRICE \$1740 inc GST

Thanks

Jayden Ewen

