

QUALITY BUILDERS PTY LTD

20 Walters Way Forrestfield WA 6058  
PO Box 303 Kalamunda WA 6926  
Ph: 9454 9700 Fax: 9454 9711

ABN: 51 881 383 907

# SHIRE OF WICKEPIN REQUEST FOR TENDER

REQUEST FOR TENDER  
REFERENCE:

DESIGN AND CONSTRUCTION OF  
ONE (1) 4x2 TRANSPORTABLE  
DWELLING DESIGNED, BUILT AND  
PLACED ON LOT 50 SMITH STREET  
WICKEPIN WA 6307

RFT NUMBER:

RFT 03 2020/2021

# CONTENTS

DOCUMENT.	PAGE NO.
Part 6. Tenderers Offer	1-8
Part 7. Contractors OS&H Management Systems Questionnaire	9-13
Part 8. Tenderers Safety Record	14-16
Part 9. Project Reference Sheet	17-23
Part 10. Tenderer Resources Schedule	24-25
Organisation Structure	26
ASC Company Extract	27
Referees	28
Sub-Contractors	29
Financial Position	30
Relevant Experience	31-36
Tenderers Resources	37
Tender Letter & Specification	38-40
Tender Architectural Plans	41
Attached	
• Quality Builders Safety Management Plan	
• Quality Builders Trust Deed	

## 6 TENDERER'S OFFER

### 6.1 FORM OF TENDER

Chief Executive Officer  
Shire of Wickepin 77 Wogolin Road  
WICKEPIN WA 6370

I/We QUALITY BUILDERS PTY LTD  
(BLOCK LETTERS)  
of 20 WALTERS WAY FORRESTFIELD WA 6155  
(ADDRESS)  
ABN 51 881 383 907 ACN (if any) 009 129 677  
Telephone No: 08 9454 9700 Facsimile No: \_\_\_\_\_  
E-mail (if any): JOHNH@QUALITYBUILDERS.COM.AU

In response to RFT 5-2019/2020 Construction of One 4x2 executive home either transportable or built on site.

Under and subject to the Conditions of Tendering annexed hereto I/we, the undersigned hereby Tender the following sum to complete the Works referred to in the Request for Tender.

FOUR HUNDRED TWENTY EIGHT THOUSAND TWO HUNDRED & NINETY EIGHT DOLLARS

(AMOUNT IN WORDS)

(\$ 428,298.00)  
(Numerals)

And I/we undertake to perform the work under the Contract in accordance with Minor Works and Services General Conditions of Contract attached to this Request and Specification, Drawings, which documents I/we have examined, and I/we agree that this Tender shall remain binding on me/us for ninety (90) calendar days from the date of the Tender closing or forty-five (45) days from the Council's resolution for determining the Tender whichever is the later unless extended on mutual agreement between the Principal and the Tenderer in writing and shall not be withdrawn during that period.

Dated this 6TH day of NOVEMBER 2020

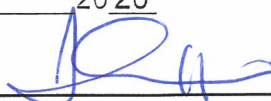
Signature of authorised signatory of Tenderer: 

Name of authorised signatory (BLOCK LETTERS): JOHN HEARNE

Position: MANAGING DIRECTOR

Address: 20 WALTERS WAY FORRESTFIELD WA 6155

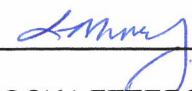
Witness Signature: 

Name of witness: (BLOCK LETTERS): LYNDA MURRAY

Address: 9 CAMBRIAN PLACE WILLETTON WA 6155

## 6.2 TENDERER'S RESPONSE

The following checklist has been provided to assist you with your submission. Where it is necessary to provide additional information please ensure that all documents are clearly marked with the relevant Attachment title to assist the evaluation panel with their assessment.

(NOTE: All pages within Part 6 are to be completed and returned to the Principal as they form part of your Tender submission).

### 6.2.1 ORGANISATIONAL PROFILE

Attach a copy of your organisation structure and provide background information on your company and label it <b>"Organisation Structure"</b> .	<b>"Organisation Structure"</b>	Tick if attached <input checked="" type="checkbox"/>
If companies are involved, attach their current ASC company extracts search including latest annual return and label it <b>"ASC Company Extracts"</b> .	<b>"ASC Company Extracts"</b>	Tick if attached <input checked="" type="checkbox"/>

### 6.2.2 REFEREES

Attach details of your referees, and label it <b>"Referees"</b> . You should give examples of work provided for your referees where possible.	<b>"Referees"</b>	Tick if attached <input checked="" type="checkbox"/>
---	-------------------	---

### 6.2.3 AGENTS

Are you acting as an agent for another party?	Yes / <input checked="" type="checkbox"/> No	
If Yes, attach details (including name and address) of your principal and label it <b>"Agents"</b> .	<b>"Agents"</b>	Tick if attached <input type="checkbox"/>

### 6.2.4 TRUSTS

Are you acting as a trustee of a trust?	<input checked="" type="checkbox"/> Yes / No	
If Yes, in an attachment labelled <b>"Trusts"</b> : (a) give the name of the trust and include a copy of the trust deed (and any related documents); and (b) if there is no trust deed, provide the names and addresses of beneficiaries.	<b>"Trusts"</b>	Tick if attached <input checked="" type="checkbox"/>

### 6.2.5 SUBCONTRACTORS

Do you intend to subcontract any of the Requirements?	<input checked="" type="checkbox"/> Yes / No	
If Yes, in an attachment labelled <b>"Subcontractors"</b> provide details of the subcontractor(s) including: (a) the name, address and the number of people employed; and (b) the Requirements that will be subcontracted.	<b>"Subcontractors"</b>	Tick if attached <input checked="" type="checkbox"/>

## 6.2.6 CONFLICTS OF INTEREST

Will any actual or potential conflict of interest in the performance of your obligations under the Contract exist if you are awarded the Contract, or are any such conflicts of interest likely to arise during the Contract?	Yes / <input checked="" type="checkbox"/> No	
If Yes, please supply in an attachment details of any actual or potential conflict of interest and the way in which any conflict will be dealt with and label it " <b>Conflicts of Interest</b> ".	"Conflicts of Interest"	Tick if attached <input type="checkbox"/>

## 6.2.7 FINANCIAL POSITION

Are you presently able to pay all your debts in full as and when they fall due?	<input checked="" type="checkbox"/> Yes / No	
Are you currently engaged in litigation as a result of which you may be liable for \$50,000 or more?	Yes / <input checked="" type="checkbox"/> No	
If you are awarded the Contract, will you be able to fulfil the Requirements from your own resources or from resources readily available to you and remain able to pay all of your debts in full as and when they fall due?	<input checked="" type="checkbox"/> Yes / No	
In order to demonstrate your financial ability to undertake this contract, in an attachment labelled " <b>Financial Position</b> " include a profit and loss statement and the latest financial return for you and each of the other proposed contracting entities, together with a list of financial referees from your bank and/or accountant.	"Financial Position"	Tick if attached <input checked="" type="checkbox"/>

## 6.2.8 QUALITY ASSURANCE

Does your organisation have any quality assurance or quality assurance systems?	Yes / <input checked="" type="checkbox"/> No	
If you propose to subcontract, does your subcontractor have a "third party" quality management system in place?	Yes / <input checked="" type="checkbox"/> No	
Supply evidence or details of your quality assurance position and where relevant of your supplier's or subcontractor's position, in an attachment labelled " <b>Quality Assurance</b> ".	"Quality Assurance"	Tick if attached <input type="checkbox"/>

## 6.2.9 INSURANCE COVERAGE

The insurance requirements for this Request are stipulated in the Special Conditions. Tenderers are to supply evidence of their insurance coverage in a format as outlined below or in an attachment labelled " <b>Insurance Coverage</b> ". A copy of the Certificate of Currency is to be provided to the Principal within 30 days of acceptance.				"Insurance Coverage"	Tick if attached <input type="checkbox"/>
Type	Insurer – Broker	Policy Number	Value (\$)	Expiry Date	
Public Liability	MARSH	AWQ024269CAR	20M	30/06/2021	
Workers Compensation	MARSH	0/18-6932	50M	30/06/2021	
Professional Indemnity	ALLIANZ/MARSH	176R000226PLP	5M 10M AGGREGATE	13/09/2021	

**6.2.10 OCCUPATIONAL SAFETY AND HEALTH**

Tenderers must complete Part 8 "Tenderer's Safety Record" and submit it marked "Tenderer's Safety Record".	"Tenderer's Safety Record"	Tick if attached <input checked="" type="checkbox"/>
Tenderers must complete Part 7 "Contractor's Occupational Health and Safety Management System Questionnaire and submit it marked "Contractor's Health & Safety Questionnaire".	"Contractor's Health & Safety Questionnaire"	Tick if attached <input checked="" type="checkbox"/>

**6.3 SELECTION CRITERIA****6.3.1 COMPLIANCE CRITERIA**

Please select with a yes or no whether you have complied with the following compliance criteria:

Description of Compliance Criteria	
(a) Compliance with the Specification contained in the Request.	<input checked="" type="checkbox"/> Yes / No
(b) Compliance with the Conditions of Tendering this Request.	<input checked="" type="checkbox"/> Yes / No
(c) Compliance with attendance at any mandatory tender briefing or Site inspection.	<input checked="" type="checkbox"/> Yes / No
(d) Compliance with the Quality Assurance requirement for this Request.	Yes / <input checked="" type="checkbox"/> No
(e) Compliance with all necessary Licences and Registrations..	<input checked="" type="checkbox"/> Yes / No
(f) Compliance with and completion of the Price Schedule.	<input checked="" type="checkbox"/> Yes / No

### 6.3.2 QUALITATIVE CRITERIA

Before responding to the following qualitative criteria, Tenderers must note the following:

- All information relevant to your answers to each criterion are to be contained within your Tender;
- Tenderers are to assume that the Evaluation Panel has no previous knowledge of your organisation, its activities or experience;
- Tenderers are to provide full details for any claims, statements or examples used to address the qualitative criteria; and
- Tenderers are to address each issue outlined within a qualitative criterion.

<b>A) Relevant Experience</b> Describe your experience in completing similar projects. Tenderers must, as a minimum, address the following information and label it <b>“Relevant Experience”</b> : (a) Provide details of similar work; (b) Provide scope of the Tenderer’s involvement including details of outcomes; (c) Provide details of issues that arose during the project and how these were managed; (d) Demonstrate sound judgement and discretion; (e) Demonstrate competency and proven track record of achieving outcomes; and (f) Complete Part 9 – “Project Reference Sheet”.	<b>Weighting 20%</b>	
	<b>“Relevant Experience”</b>	Tick if attached <input checked="" type="checkbox"/>

<b>B) Tenderer’s Resources</b> Tenderers should demonstrate their ability to supply and sustain the necessary: (a) Plant, equipment and materials; and (b) Any contingency measures or back up of resources including personnel (where applicable). As a minimum, Tenderers should provide a current commitment schedule and plant/equipment schedule in an attachment and label it <b>“Tenderer’s Resources”</b> .	<b>Weighting 20%</b>	
	<b>“Tenderer’s Resources”</b>	Tick if attached <input checked="" type="checkbox"/>

### 6.4 PRICE INFORMATION

Tenderers **must** complete the following Price Schedule. Before completing the Price Schedule, Tenderers should ensure they have read this entire Request.

#### 6.4.1 DISCOUNTS

Are you prepared to allow a discount for prompt settlement of accounts?	<input checked="" type="checkbox"/> Yes <input type="checkbox"/> No	
If you are offering different discounts for different periods, or other discounts such as volume discounts, detail them in an attachment labelled <b>“Discounts”</b> .	<b>“Discounts”</b>	Tick if attached <input type="checkbox"/>

6.4.2 PRICE BASIS

Are you prepared to offer a fixed price?	<input checked="" type="radio"/> Yes	No
--	--------------------------------------	----

If No, please indicate how your proposed price variation mechanism differs from the one outlined above. Supply details and label it "Price Variation Mechanism".	"Price Variation Mechanism"	Tick if attached <input type="checkbox"/>
--	-----------------------------	--



**6.4.3 SCHEDULE OF RATES FOR LABOUR AND DAYWORKS**

The Tenderer shall list below the hourly rates payable for various occupational groups which may be employed on the Site including any applicable Goods and Services Tax (GST).

ITEM	RATE PER HOUR (ex GST)	GST Component	RATE PER HOUR (inc GST)
Planner or Draftsperson	\$ 61.88	\$ 6.19	\$ 68.07
Supervisor	\$ 82.50	\$ 8.25	\$ 90.75
Building Tradesperson	\$ 75.00	\$ 7.50	\$ 82.50
Labourer	\$ 56.25	\$ 5.63	\$ 61.88
Plant Operator	\$ 75.00	\$ 7.50	\$ 82.50

**6.4.4 SCHEDULE OF RATES FOR PLANT HIRE**

Tenderers shall list the hourly rates for the hire of all types of constructional equipment used on the Site for clearing, earthworks, excavation, compaction, laying of pipes, construction of manholes, grading of surfaces and watering.

The rates shall include allowance for an experienced operator, fuel consumable sores, maintenance, overheads, GST and profit and are for the plant specified or equivalent, based on the Contractors standard working week.

ITEM	RATE PER HOUR (ex GST)	GST Component	RATE PER HOUR (inc GST)
BOBCAT	\$ 130.00	\$ 13.00	\$ 143.00
TRUCK 8 TONNE	\$ 110.00	\$ 11.00	\$ 121.00
	\$	\$	\$
	\$	\$	\$

Working week for these rates is MONDAY to FRIDAY for 8 hours/day.

**6.4.5 PRICE SCHEDULE**

Tenderers must complete the following Price Schedule. Before completing the Price Schedule, Tenderers should read this entire Request for Tender.

The Tenderer shall price all tasks in the Price Schedule. The prices entered shall fully cover all the obligations of the Contractor under the Contract.

**BREAK DOWN OF LUMP SUM**

NO.	TASK	AMOUNT
	<i>Design</i>	
1.	Architectural Plans	\$696.48
	<i>Construction</i>	
2.	Preliminaries	\$17,330.00
3.	Site Works	\$50,925.00
4.	Construction – Lot 50 Smith Street	\$295,720.34
7.	Services – connection to power, water, sewer & phone	\$24,690.00
	<b>TOTAL LUMP SUM PRICE (EX GST)</b>	<b>\$389,361.82</b>
	<b>TOTAL GST COMPONENT</b>	<b>\$38,936.18</b>
	<b>TOTAL LUMP SUM PRICE (INC GST)</b>	<b>\$428,298.00</b>

FOUR HUNDRED TWENTY EIGHT THOUSAND TWO HUNDRED & NINETY EIGHT DOLLARS

Amount in words:

Options

NO.	TASK	AMOUNT
	<i>Environmental/Energy Efficient Initiatives</i>	
8.	Grid Connected Solar Power 2.5-3.5kw	\$3,399.00 INC GST
9.	Water Reuse system	
	<i>Optional Construction Design Alternatives</i>	
10.	Construction – Lot 50 Smith Street	
13.	Other initiatives – as identified by the Builder	

## 7 CONTRACTOR'S OCCUPATIONAL SAFETY AND HEALTH MANAGEMENT SYSTEM QUESTIONNAIRE

This questionnaire forms part of the Principal's Tender evaluation process and is to be completed by tenderers and submitted with their Tenders and labelled as "Contractor's Safety & Health Questionnaire". The objective of the questionnaire is to provide an overview of the status of Contractor's safety management system. Contractors may be required to verify their responses noted in their questionnaire by providing evidence of their ability and capacity in relevant matters.

OSH Policy and Management	YES	NO
<p>Is there a written company health and safety policy? If Yes, provide a copy of the policy.</p> <p>Comments SEE ATTACHED</p> <hr/> <hr/>	<input checked="" type="checkbox"/>	<input type="checkbox"/>
<p>Does the company have an OSH Management System? If Yes, provide details.</p> <p>QUALITY BUILDERS HAVE A SAFETY MANAGEMENT PLAN (SMP) THIS SAFETY MANAGEMENT PLAN CAN BE PROVIDED ELECTRONICALLY AS REQUIRED</p>	<input checked="" type="checkbox"/>	<input type="checkbox"/>
<p>Is the OSH Management System audited or reviewed on a regular basis? If Yes, provide details of last audit and outcomes.</p> <p>OUR SMP WAS LAST AUDITED ON 7/6/2019 AND IS UPDATED ON A REGULAR BASIS FOR JOB SPECIFIC REQUIREMENTS</p>	<input checked="" type="checkbox"/>	<input type="checkbox"/>
<p>Is there a company OSH organisation chart? If Yes, provide a copy.</p> <p>Comments OSH ORGANISATION CHART IS CONTAINED IN THE SMP</p> <hr/> <hr/>	<input checked="" type="checkbox"/>	<input type="checkbox"/>
<p>Are Health and safety responsibilities clearly identified for all employees? If Yes, provide details.</p> <p>RESPONSIBILITIES ARE OUTLINED IN THE SMP</p> <hr/> <hr/>	<input checked="" type="checkbox"/>	<input type="checkbox"/>
<p>Are line managers held accountable for health and safety performances? If Yes, provide details.</p> <p>ACCOUNTABILITY IS OUTLINED IN THE SMP</p> <hr/> <hr/> <hr/>	<input checked="" type="checkbox"/>	<input type="checkbox"/>

Safe Work Practices and Procedures	YES	NO
<p>Has the company prepared safe operating procedures or specific safety instructions relevant to its operations? If Yes, provide a summary listing of procedures or instructions.</p> <p>Comments SWMS - ANGLE GRINDER, BOCAT WORK, ERECTION OF STRUCTURES (ROOF &amp; WALL), MANUAL HANDLING, ROOF SHEETING, WORKING AT HEIGHTS</p>	<input checked="" type="checkbox"/>	<input type="checkbox"/>
<p>Are safe operating procedures or specific safety instructions issued to employees? If Yes, please explain how this is done.</p> <p>VIA SWMS, MEMO OR VERBALLY</p>	<input checked="" type="checkbox"/>	<input type="checkbox"/>
<p>Does the company have any permit to work systems? If Yes, provide a copy of a standard incident report form.</p>	<input type="checkbox"/>	<input checked="" type="checkbox"/>
<p>Which company personnel are responsible for investigating incidents? MANAGING DIRECTOR &amp; PROJECT MANAGER (PM)</p>		
<p>Do incident reports contain prevention recommendations?</p> <p>Who is responsible for implementing remedial measures recommended? MANAGING DIRECTOR (MD)</p>	<input checked="" type="checkbox"/>	<input type="checkbox"/>
<p>Are these procedures to maintaining, inspecting and assessing the hazards of Plant operated/owned by the company? If Yes, provide details.</p> <p>REGULAR ASSESSMENT &amp; INSPECTION OF PLANT BY MD &amp; PM ALONG WITH RISK ASSESSMENTS</p>	<input checked="" type="checkbox"/>	<input type="checkbox"/>
<p>Are their procedures to storing and handling hazardous substances? If Yes, provide details.</p> <p>SUBSTANCES ARE STORED IN FLAMBLE PROOF CABINET</p>	<input checked="" type="checkbox"/>	<input type="checkbox"/>
<p>Are there procedures for assessing and controlling risks associated with manual handling? If Yes, provide details.</p> <p>THESE ARE DETAINED IN OUR SMP</p>	<input checked="" type="checkbox"/>	<input type="checkbox"/>

**Occupation Safety and Health**

Describe how safety and health training is conducted in your company?

AS TRAINING IS REQUIRED A THIRD PARTY PROVIDER

IS ENGAGED, GENERAL ITEMS ARE HANDLE IN HOUSE BY

OUR EXPERIENCED STAFF

Provide a summary or examples of safety and health training courses provided for, or undertaken by employees during the past 12 months.

NOTHING IN THE PAST 12 MONTHS (EXCLUDING FORK TRUCK LIC)

PRIOR TO THAT WORKING AT HEIGHTS

Is a record maintained of all training and induction programs undertaken for employees in your company?  
If Yes, provide examples of safety training records.

Provide details of any company safety induction programs for company employees and or/Sub contractors.

A GENERAL SAFETY INDUCTION IS CARRIED OUT BY PM OR MD  
FOR NEW SUB-CONTRACTORS OR EMPLOYEES

### Safety and Health Workplace Inspection

	YES	NO
<p>Are regular health and safety inspections at work Sites undertaken? If Yes provide details. <u>AS QUALITY BUILDERS WORK FROM A CONSTRUCTION YARD SAFETY INSPECTIONS ARE CONTROLLED ON A DAILY BASIS</u></p>	<input checked="" type="checkbox"/>	<input type="checkbox"/>
<p>Are standard work place inspection checklist used to conduct health and safety inspections? If Yes, provide details or examples. <u>DETAILS AND PROCESSES ARE INCLUDE IN THE SMP</u></p>	<input checked="" type="checkbox"/>	<input type="checkbox"/>
<p>Who normally completes workplace safety and health inspections? <u>GENERALLY MD &amp; PM'S</u></p>		
<p>How are workplace safety and health inspection reports dealt with? <u>THEY ARE DISCUSSED WITH MD &amp; PM'S, AND ACTIONED AS REQUIRED</u></p>		
<p>Is there a procedure by which employees can report hazards at workplaces? If Yes, provide details. <u>HAZARD CAN AND ARE REPORTED DIRECTY TO THE MD &amp; PM'S AND ACTIONED</u></p>	<input checked="" type="checkbox"/>	<input type="checkbox"/>

Safety and Health Consultation	YES	NO
Is there a workplace safety committee? If Yes, provide details. _____ _____	<input type="checkbox"/>	<input checked="" type="checkbox"/>
Are there guidelines on procedures governing the safety committee operation?	<input type="checkbox"/>	<input checked="" type="checkbox"/>
Are there employee elected health and safety representatives If Yes, provide details. _____ _____	<input type="checkbox"/>	<input checked="" type="checkbox"/>
Is there a company safety officer? Comments: <u>SAFETY AND SAFETY REQUIRMENTS ARE HANDED BY THE</u> <u>MANAGING DIRECTOR</u>	<input checked="" type="checkbox"/>	<input type="checkbox"/>
<b>Safety and Health Performance Monitoring</b>		
Is there a system for recording and analysing and safety performance statistics? If Yes, provide details. _____ _____	<input type="checkbox"/>	<input checked="" type="checkbox"/>
Is safety performance on the agenda of management meetings? If Yes, provide details. _____ _____	<input type="checkbox"/>	<input checked="" type="checkbox"/>
Is senior management involved in analysis of safety performance statistics? _____ _____	<input type="checkbox"/>	<input checked="" type="checkbox"/>
Has the company ever been convicted of an occupational health and safety offence? If Yes, provide details. <u>DATE OF ORDER 8/12/2011 FOR A FALL INJURY IN JULY 2008 FINE \$4,000</u> _____ _____	<input checked="" type="checkbox"/>	<input type="checkbox"/>







Tenderer's Safety Record

Quality Builders PTY LTD  
HIA Safety Services  
Construction Safety Plan

FIRST AID / INCIDENT REGISTER

Date	Name	Description of Work Activity	Injury or Illness Sustained	Reported To
2/9	Corey Fowler	Carpentry	Fractured teeth	Jason Hitchins
4/9	Cameron M.	Welder	Cuts to hand	seen by Kelly Taylor
27/10	Brett Pears	Welder.	object in eye.	JLH / KT
28/4	Liam Hearne	Apprentice	burn fingers	JLH
4/6/15	Brody Wood	APPRENTICE.	HAND PAIN.	JLH. / JH
10/6	Brett Pears	Welder.	Cut to @ arm.	JLH/KT
30/10	Reece Annan.	Apprentice.	twisted ankle.	JLH / KT
18/1/16	Reece Annan	Apprentice.	Cut to arm	KT.
29/1/16	Glenn Sampson	Yard.	R hand.	Ray M
	Liam Hearne.	Apprentice.	Thumb / Hand	SM Childress James G.
17/8/16	M Adams.	Yardman.	knuckle	KT.
	K Pontague	Carpentry	burn to arm	KT
7.10.16	Jamie	Carpentry	Laceration - leg	KTaylor
7.10.16	D Grafham	Apprentice	Laceration - leg	KTaylor
20.10.16	C Hawkins	welder	object in eye	K Taylor
16.1.17	Jed Palmer	Welder :-	wire puncture finger	K Taylor
21.12.16	G Sampson	Yardman	Cut to leg	K Taylor
15.3.17	M Adams	Yardman	Head/ear injury	K Taylor.
5/4/17	Brett Pears	Welder.	Cut - thumb	K Taylor
	B Wood	Apprentice	Cut to Finger	M Juratte
5.9.17	C Munachen	Welder.	ankle.	K Taylor.
	D Tester.	Carpenter.	Cut to drumstick	
14.11.17			@ hand	K Taylor
		Westcoast HVAC	Wet Breathing	K Taylor
7.2.18	Brett Pears	Welder.	Laceration @ Finger	K Taylor
8.2.18	Glenn Sampson	Yard	Crush/L to R hand	K Taylor.
28.8.18	Jed Palmer	Welder	(D) shin Ring finger	
			cut on frame	K Taylor.
12/4/19	Kareem	Apprentice	Laceration Finger	KTaylor
	M Adams	Yardman	Flo in eye	K Taylor
	M Handgraaf	Carpenter.	Cut to @ wrist	K Taylor
	M Geere	Carpenter	Cut to thumb.	K Taylor



Project Completion Date	Company Name - Quality Builders Pty Ltd			Completed Projects June 2011 - Sept. 2020		
	Project Name	Type of Works	Project Value Inc. GST	Construction Period	Client/Reference	Facility Complexity
15/09/2020	Stimulus Program - Demountable Replacements - 18 x GLA Classrooms	Construction of 18 x GLA Classrooms + 10 x Additional GLA Classroom Variation	\$3,895,374	28 Weeks	DoF - Dept. of Ed. Iredale Pedersen Hook Architects - Adrian Iredale 9322 9750	Level 2 Simple
15/09/2020	Transportable Construction Program - Package 6 - 27 x GLA Classrooms	Construction of 27 x GLA Classrooms + 3 x Additional GLA Classroom Variation	\$3,995,226	28 Weeks	DoF - Dept. of Ed. Iredale Pedersen Hook Architects - Adrian Iredale 9322 9750	Level 3 Simple
23/06/2020	Eucla DoH 1 x 4 Bedroom Transportable Houses	1 x 4 Bedroom D&C Transportable Houses	\$522,144	26 Weeks	Dept. of Housing - Sander Dijkstal	Conventional
7/05/2020	Regional TAFE Bunbury NDIS Training Facility Transportables	Construction of NDIS Training Facility Transportable & 2 x GLA Classrooms	\$530,620	14 Weeks	DoF - Department of Training and Workplace Development - Kent Lyon Architects - 9791 5404	N/A
8/07/2020	Shire of Murchison - Two residential dwellings - 3x2 and 4x2 design, construction and supply Transportable Houses	Design & Construction of 4 Bedroom x 2 Bathroom & 3 Bedroom x 2 Bathroom Transportable dwelling	\$706,536	26 Weeks	Shire of Murchison - Bill Boehm - 9963 7999	N/A
22/05/2020	Transportable Construction - Additions 2019-2020 3x Specialist and 4x GLA Classrooms	Construction of 3x Specialist Classrooms (Woodwork, Metalwork & Science) and 4x GLA Classrooms + 2 x Additional GLA Classroom Variation	\$1,700,540	27 Weeks	DoF - Dept. of Ed. Iredale Pedersen Hook Architects - Adrian Iredale 9322 9750	Level 1 Simple
21/01/2020	Oberthur Primary School - 2 x Modified Early Childhood Education Transportable	Construction of 2 x Modified Early Childhood Education Transportable	\$276,275	12 Weeks	DoF - Dept. of Ed. Iredale Pedersen Hook Architects - Adrian Iredale 9322 9750	Level 1 Simple
21/01/2020	Shire of Koorda 1 x 3 Bed/2 Bath Transportable House	Design & Construction of 3 Bedroom x 2 Bathroom Transportable dwelling	\$315,294	26 Weeks	Shire of Koorda	N/A
23/03/2019	Transportable Program 2019/20 - Package 2 - 5 x Pre-primary Classrooms and 1 x Administration Building + 1 Additional Pre-primary Classroom Variation	Construction of 5 x Pre-primary Classrooms and 1 x Administration Building + 1 Additional Pre-primary Classroom Variation	\$1,155,477	24 Weeks	DoF - Dept. of Ed. Iredale Pedersen Hook Architects - Adrian Iredale 9322 9750	Level 1 Conventional
16/12/2019	Transportable Program 2019/20 - Package 2 - 27 x GLA Modular Classrooms	Construction of 27 x GLA Transportable Classrooms	\$3,095,423	23 Weeks	DoF - Dept. of Ed. Iredale Pedersen Hook Architects - Adrian Iredale 9322 9750	Level 1 Conventional
16/12/2019	Transportable Program 2019/20 - Package 1 - 27 x GLA Modular Classrooms	Construction of 27 x GLA Transportable Classrooms	\$3,095,423	23 Weeks	DoF - Dept. of Ed. Iredale Pedersen Hook Architects - Adrian Iredale 9322 9750	Level 1 Conventional
23/03/2019	Harrisdale Senior High School - Double Storey General Learning Area Transportable Block	Design & Construction of 4 GLA Classrooms, with 2 x Breakout rooms, associated Verandahs, composite decking handrails, ramps, staircases and mechanical lift.	\$1,058,078	20 Weeks	DoF - Dept. of Ed. Iredale Pedersen Hook Architects - Adrian Iredale 9322 9750	Level 1 Simple
23/03/2019	New Transportable Classrooms - Rockingham Beach Education Support Centre (Programmed FM)	Double Modular GLA classroom with office including verandah & site works	\$492,132	17 Weeks	Programe Facility Management for Dept. of Education	N/A
6/12/2018	Transportable Program 2018 - Package 3 - 5 x AAT's, 5 x Toilet Blocks, and 4 x Admin Buildings	Construction of 10 toilet blocks & 4 Administration buildings	\$1,458,019	20 Weeks	DoF - Dept. of Ed. Iredale Pedersen Hook Architects - Adrian Iredale 9322 9750	Level 1 Conventional
5/11/2018	Transportable Program 2018 - Package 2 - 5 x Pre-primary Classrooms and 10 x Sheds	Construction of 5 x Pre-primary Classrooms and 10 x Sheds	\$1,069,948	18 Weeks	DoF - Dept. of Ed. Iredale Pedersen Hook Architects - Adrian Iredale 9322 9750	Level 1 Simple
12/01/2017	Transportable Program 2018 - Package 1 - 12 x GLA Classrooms	Construction of 12 x GLA Transportable Classrooms	\$1,464,630	17 Weeks	DoF - Dept. of Ed. Iredale Pedersen Hook Architects - Adrian Iredale 9322 9750	Level 1 Simple
7/09/2018	Wooroloo Prison Accomodation Units	Supply and Installation of Modular Buildings at Wooroloo Prison Farm	\$1,507,365	16 Weeks	DoF - Corrective Services. COX Architects - Mark Hainsworth 9322 3644	Level 1 Conventional
24/04/2018	St. Lawrence Double Classroom	Transportable Double Classroom - Design & Construct, Supply & Install	\$325,226	N/A	Catholic Education - Eastman Poletti Sherwood Architects Bruce Sherwood 9964 4949	N/A

Building Projects

Company Name - Quality Builders Pty Ltd			Completed Projects June 2011 - Sept. 2020			
Project Completion Date	Project Name	Type of Works	Project Value Inc. GST	Construction Period	Client/Reference	Facility Complexity
28/04/2016	Narrogin DoH 1 x 4 Bedroom Transportable Houses	1 x 4 Bedroom D&C Transportable Houses	\$408,741		Dept. of Housing - Anna Tay 9222 8152	Conventional
23/07/2018	Meekatharra DoH Construction of 3 x 2 bedroom dwellings	Construction of 3 x 2 bedroom dwellings	\$981,584	33 Weeks	Dept of Housing - Joan Lim 9222 4796 Adam Lucas 3437 386 345	Conventional
12/12/2017	12 x General Learning Area Classrooms 2017 - Package 3	Construction of 12 x GLA Transportable Classrooms	\$1,417,677	19 Weeks	DoF - Dept. of Ed. Iredale Pedersen Hook Architects - Adrian Iredale 9322 9750	Level 1 Simple
8/01/2018	Package 2 - 25 General Learning Area Classrooms	Construction of 25 x GLA Transportable Classrooms	\$3,002,854	21 Weeks	DoF - Dept. of Ed. Iredale Pedersen Hook Architects - Adrian Iredale 9322 9750	Level 2 Conventional
28/04/2016	Merredin DoH 1 x 4 Bedroom Transportable Houses	1 x 4 Bedroom D&C Transportable Houses	\$367,252		Dept. of Housing - Joan Lim 9222 4796 Peter Haxby 0433 123 233	Conventional
3/10/2018	Pingelly Aged Appropriate Accommodation	Construction of 1 x Single & 2 x Duplex Transportable Houses including site works	\$1,528,077	32 Weeks	Shire of Pingelly - Gavin Pollock 98871066 Iredale Pedersen Hook Architects - Adrian Iredale 9322 9750	Conventional
8/01/2018	Transportable School Buildings Package 1 - 24 Pre-primary Classrooms and 20 Sheds	Construction of 24 Pre-primary Classrooms and 20 Transportable Sheds	\$4,543,304	26 Weeks	DoF - Dept. of Ed. Iredale Pedersen Hook Architects - Adrian Iredale 9322 9750	Level 3 Conventional
22/01/2018	Cue DoH 1 x 4 Bedroom Transportable Houses	1 x 3 Bedroom D&C Transportable Houses	\$430,768	33 Weeks	Dept. of Housing - Dexter Pereira 9222 44846 Adam Lucas 0437 286 345	Conventional
21/12/2017	Mt Margaret DoH 2 x 3 Bedroom Transportable House	Construction of 2 x 3 Bedroom D&C Transportable Houses	\$775,609	35 Weeks	Dept. of Housing - Dexter Pereira 9222 44846 Peter Haxby 0433 123 233	Conventional
23/08/2017	Exmouth Police Custodial Upgrade	Construction - Exmouth Police Station Custodial Upgrade including site works	\$1,240,480	22 Weeks	DoF - BMW - Neil Hatt 99415101. Oldfield Knott Ian Moores 94892281	Level 1 Conventional
10/04/2018	Yanchep Police Station Custodial Upgrade	Two stage expansion and upgrading of the Yanchep Police Station	\$2,390,605		DoF - BMW - Conan Tye 65512069. Oldfield Knott Ian Moores 94892281	Level 2 Conventional
20/12/2016	25 Transportable General Learning Area Classrooms 2016/2017 - Package 3	Construction of 25 x GLA Transportable Classrooms	\$2,924,614	22 Weeks	DoF - Dept. of Ed. Iredale Pedersen Hook Architects - Adrian Iredale 9322 9750	Level 3 Conventional
12/04/2017	Karratha & Broome Courthouse Upgrades	Relocate Kununurra Temporary Courthouse to Broome & Karratha include siteworks & upgrades	\$4,765,250	26 Weeks	DoF - BMW - Conan Tye 65512069. TAG Architects Daniel Bubnich 92270511	Level 2 Conventional
22/03/2017	Corrigin DoH 1 x 4 Bed & 1 x 3 Bed Transportable Houses	1 x 4 & 1 x 3 Bedroom Transportable Houses	\$672,776	24 Weeks	Dept. of Housing - Mark Ainslie 9222 8155	Conventional
1/03/2017	Paraburdoo DoH 1 x 4 Bedroom Transportable Houses	1 x 4 Bedroom Transportable House	\$402,836	24 Weeks	Dept. of Housing - Mark Ainslie 9222 8155	Conventional
1/03/2017	Koorada DoH 1 x 4 Bedroom Transportable Houses	1 x 4 Bedroom Transportable House	\$381,434	24 Weeks	Dept. of Housing - Mark Ainslie 9222 8155	Conventional
25/10/2017	Exmouth x 20 Houses	20 Transportable Single & Double Story Houses	\$5,441,711	24 Weeks	Dept. of Housing - Mark Ainslie 9222 8155	Conventional
25/11/2016	Construction of 15 Transportable Sheds	15 x Region D Cyclonic Sheds	\$172,762	8 Weeks	DoF - Dept. of Ed. - Rami Akila 65511733	Conventional
19/09/2016	Construction of 15 Transportable Sheds	15 x Region D Cyclonic Sheds	\$175,521	8 Weeks	DoF - Dept. of Ed. - Rami Akila 65511733	Conventional
FY 2016/2016 to 31/12/16	Dept. of Finance- Transportable Building Relocation Services	Multiple Projects including Refurbishment of Existing Education Buildings	\$1,953,687	52 Week Period	BMW Transportables - Gary Cox 6551 1744	Conventional

Building Projects

Company Name - Quality Builders Pty Ltd		Completed Projects June 2011 - Sept. 2020				
Project Completion Date	Project Name	Type of Works	Project Value Inc. GST	Construction Period	Client/Reference	Facility Complexity
12/01/2017	25 + 25 Transportable General Learning Area Classrooms 2015/2016 - Package 3	25 + 25 GLA Transportable Classrooms	\$5,964,391	22 Weeks	DoF - Dept. of Ed. Iredale Pedersen Hook Architects - Adrian Iredale 9322 9750	Level 3 Conventional
15/10/2016	25 Transportable General Learning Area Classrooms 2015/2016 - Package 2	25 GLA Transportable Classrooms	\$3,229,982	22 Weeks	DoF - Dept. of Ed. Iredale Pedersen Hook Architects - Adrian Iredale 9322 9750	Level 3 Conventional
11/07/2016	32 Transportable GLA Classrooms	32 GLA Transportable Classrooms	\$3,877,219	22 Weeks	DoF - Dept. of Ed. Iredale Pedersen Hook Architects - Adrian Iredale 9322 9750	Level 3 Conventional
		<b>Combined total of Classroom Packages 1, 2 &amp; 3</b>	<b>\$13,071,592</b>			
28/04/2016	Construction of 15 Transportable Sheds	15 x Region D Cyclonic Sheds	\$189,375	8 Weeks	DoF - Dept. of Ed. - Rami Akila 65511733	Conventional
28/04/2016	Norseman DoH 1 x 4 Bedroom Transportable Houses	1 x 4 Bedroom Transportable Houses	\$374,565	24 Weeks	Dept. of Housing - Mark Ainslie 9222 8155	Conventional
26/04/2016	Mt. Magnet DoH 1 x 4 Bedroom Transportable Houses	1 x 4 Bedroom Transportable Houses	\$348,601	24 Weeks	Dept. of Housing - Mark Ainslie 9222 8155	Conventional
FY 2015/2016	Dept. of Finance- Transportable Building Relocation Services	Multiple Projects including Refurbishment of Existing Education Buildings	\$5,218,488	52 Week Period	BMW Transportables - Gary Cox 6551 1744	Conventional
22/12/2015	Woodwork Design and Technology x 2, Metalwork Design and Technology x 1.	Woodwork Design and Technology x 2, Metalwork Design and Technology x 1 Classroom	\$814,010	20 Weeks	DoF - Dept. of Ed. Iredale Pedersen Hook Architects - Adrian Iredale 9322 9750	Level 1 Conventional
21/03/2016	Laverton DoH 1 x 4 Bedroom Transportable Houses	1 x 4 Bedroom Transportable Houses	\$360,295	24 Weeks	Dept. of Housing - Mark Ainslie 9222 8155	Conventional
18/12/2015	Salmon Gums DoH 1 x 4 Bedroom Transportable Houses	1 x 4 Bedroom Transportable Houses	\$386,969	24 Weeks	Dept. of Housing - Mark Ainslie 9222 8155	Conventional
FY 2014/2015	Dept. of Finance- Transportable Building Relocation Services	Multiple Projects including Refurbishment of Existing Education Buildings	\$4,600,000	52 Week Period	BMW Transportables - Gary Cox 6551 1744	Conventional
3/11/2015	Wickham 2 x 3 Bedroom and 2 x 4 Bedroom Transportable Houses	4 x Design & Construct GROH houses for Wickham	\$1,369,769	35 Weeks	Dept. of Housing - Mark Ainslie 9222 8155	Conventional
25/08/2015	St Lawrence Primary School - Classrooms & Ablution Block	Transportable Classrooms (2) & Ablution Block (1)	\$357,328	20 Weeks	Catholic Education - Eastman Poletti Sherwood Architects Bruce Sherwood 9964 4949	Conventional
24/07/2015	Construction of Administration and Toilet Transportables for Various Schools	Blocks (Two Types) and Six Transportable Toilet Blocks (Four Types)	\$1,499,750	22 Weeks	DoF - Dept. of Education - Parry & Whyte Architects, Alec Whyte 9388 1139	Level 2 Conventional
1/05/2015	Albany Regional Prison Clinic	1 x Prison Health Clinic	\$134,920	16 Weeks	Dept. of Finance - Roberts Gardiner Architects	Conventional
7/04/2015	Mullewa Lot, 12, Lot 14, Lot 80, Lot 590 Mills Street	6 x Design & Construct GROH houses for Mullewa	\$2,199,985	49 Weeks	Dept. of Housing - Mark Ainslie 9222 8155	Conventional
30/03/2015	Lot 133, Lot 134, Lot 135 Waano Crescent Paraburdoo	3 x Design & Construct GROH houses for Paraburdoo	\$1,309,328	35 Weeks	Dept. of Housing - Mark Ainslie 9222 8155	Conventional
30/03/2015	New Transportable Classroom for Carson Street School	1 x Transportable Pre-Primary Classroom	\$298,488	18 Weeks	Dept. of Finance - Facility Management	Programmed Conventional

Building Projects

Company Name - Quality Builders Pty Ltd				Completed Projects June 2011 - Sept. 2020		
Project Completion Date	Project Name	Type of Works	Project Value Inc. GST	Construction Period	Client/Reference	Facility Complexity
16/01/2015	Department of Education - Two Transportable Science Classrooms For Newman SHS	2 x Transportable Science Classrooms	\$688,200	8 Weeks	DoF - Dept. of Ed. Iredale Pedersen Hook Architects - Adrian Iredale 9322 9750	Level 3 Conventional
20/11/2014	Transportable GLAs by Design & Construction - 2014	10 Design & Construct GLA Classrooms	\$1,400,628	16 Weeks	DoF - Dept. of Education Paterson Group - Greg Paterson 9485 2122	No Pre-Qual applied
17/10/2014	Specialist Transportable Classroom Buildings	Construction of 1 x Design and Technology Workshops, 10 x Science Laboratories, 2 x Home Economics (composite), 2 x Home Economics (food only)	\$5,266,319	32 Weeks	DoF - Dept. of Ed. Iredale Pedersen Hook Architects - Adrian Iredale 9322 9750	Level 3 Conventional
15/07/2014	Nickol Bay Hospital - Outpatients Transportable	Construction of Transportable Health Clinic including siteworks	\$1,799,406	28 Weeks	DoF - WA Country Health - Bateman Architects Norm Bateman 9382 8220	Level 1 Conventional
9/07/2014	Eucla GROH Housing	2 x Design & Construct GROH houses for Eucla	\$1,204,197	20 Weeks	Dept. of Housing - Steve Blower 9222-4792	Conventional
30/05/2014	Transportable GLA Classroom Units - Design & Construct - Package 2	10 Design & Construct GLA Classrooms	\$1,430,275	15 Weeks	DoF - Dept. of Education Paterson Group - Greg Paterson 9485 2122	No Pre-Qual applied
21/02/2014	Curtin University Decant Village - Building 502	Construction of 4 x Teaching, Lecture, Toilets & Administration Buildings	\$4,350,000	21 Weeks	Curtin University - Parry & Rossenthal Architects - Wai Kin 9481 0540	Private Project
20/01/2014	Early Childhood Education Classrooms and Sheds - Design & Manufacture	15 x ECE Classrooms & 25 x Sheds	\$3,733,342	30 Weeks	DoF - Dept. of Ed. Iredale Pedersen Hook Architects - Adrian Iredale 9322 9750	Level 3 Conventional
16/01/2014	Wanarn Community School Transportable Toilet Blocks	Construction of 2 x Transportable Toilet Blocks	\$329,813	22 Weeks	DoF - Dept. of Education - Parry & Whyte Architects - Alec Whyte 9388 1139	Level 1 Conventional
16/12/2013	Transportable School Buildings: Administration building for Nullagine Primary School	1 x Administration Building & Parasol roof	\$308,660	16 Weeks	DoF - Dept. of Ed. Iredale Pedersen Hook Architects - Adrian Iredale 9322 9750	Level 1 Conventional
28/11/2013	Transportable GLA Classroom Units - Design & Construct	20 Design & Construct GLA Classrooms	\$2,789,300	25 Weeks	DoF - Dept. of Education Paterson Group - Greg Paterson 9485 2122	No Pre-Qual applied
13/11/2013	Transportable Universal Access Toilet	Construction of 5 x Transportable Universal Access Toilet Blocks 2013	\$496,683	16 Weeks	DoF - Dept. of Education - Parry & Whyte Architects - Alec Whyte 9388 1139	Level 1 Conventional
14/10/2013	General Classroom Areas, Early Childhood Education, Kindergartens and Sheds - Design & Manufacture	15 x GLA Classrooms, 11 x Pre Primary Classrooms, 11 x Sheds and 2 x Kindergartens	\$5,489,611	30 Weeks	DoF - Dept. of Education Paterson Group - Greg Paterson 9485 2122	Level 3 Conventional
27/06/2013	Design and Construction of Factory built houses, transport and Commissioning in Port Hedland	5 x Design & Construct houses for South Hedland	\$1,845,546	22 Weeks	Dept. of Housing - Steve Blower 9222-4792	Conventional
14/05/2013	General Classroom Areas, Early Childhood Education and Sheds - Design & Manufacture	21 x GLA Classrooms, 23 x ECE Classrooms, 1 x Administration Building & 23 x Sheds	\$6,928,491	24 Weeks	DoF - Dept. of Ed - Parry & Rossenthal Architects - Wai Kin 9481 0540	Level 4 Conventional

Building Projects

Project Completion Date	Company Name - Quality Builders Pty Ltd			Completed Projects June 2011 - Sept. 2020		
	Project Name	Type of Works	Project Value inc. GST	Construction Period	Client/Reference	Facility Complexity
3/04/2013	Useless Loop GROH Housing	3 x Design & Construct GROH houses for Useless Loop	\$1,314,514	22 Weeks	Dept.of Housing - Teakle & Laylor - Peter Teakle 3964 1382	Conventional
26/03/2013	Child and Parent Centre South Hedland Primary School	Construction of Transportable Child and Parent Centre including siteworks	\$818,616	25 Weeks	DoF - Dept. of Education - Broderick Architects Eamon Broderick 9381 3011	Level 1 Conventional
19/03/2013	Esperance Hospital - Interam Medical Centre, Consulting rooms	Transportable medical centre & site works - Design, Manufacture & Install	\$1,597,900	21 Weeks	DoF - WA Area Health Service Peter Hunt Architects - Andrew Jones 9322 6033	Level 1 Simple
8/02/2013	Design and Construction of five houses in South Hedland	5 x Design & Construct houses for South Hedland	\$1,823,252	22 Weeks	Dept. of Housing - Steve Blower 9222-4792	Conventional
31/01/2013	John Paul College Classroom	1 x Transportable Classroom & site works - Design, Manufacture & Install	\$490,875	20 Weeks	Catholic Education - Santelli Architects Andrew Myers 9328 3711	Conventional
12/12/2012	St. Lawrence Kindergarten	Transportable Kindergarten Buildings - Design & Construct, Supply & Install	\$505,200	18 Weeks	Catholic Education - Eastman Poletti Sherwood Architects Bruce Sherwood 9964 4949	Conventional
1/10/2012	Multi Function Police Facilities	Transportable Police Station & complete site works for Blackstone, Burringurah & Looma	\$15,371,485	50 Weeks	DoF - WA Police - GHD Architects Ian Nelligan & Gary Townsend 9481 7119	Level 3 Conventional
13/09/2012	Kununurra Temporary Courthouse	Temporary Court house & Site works - Design, Manufacture & Install	\$4,019,040	48 Weeks	DoF - Dept. of Att. General - Saleeba Adams Arch. - Grant Adams 9381 4422	Level 3 Conventional
6/09/2012	Kalumburu GLA Classrooms & Parasol Shade Structure	4 x Transportable classrooms - Design & Manufacture	\$801,550	14 Weeks	DoF - Dept. of Ed - Parry & Rossenthal Architects - Wai Kin 9481 0540	Level 1 Conventional
20/06/2012	Derby Police Station	Transportable Police Station, demolition, refurbishment & complete site works	\$4,477,817	50 Weeks	DoF - WA Police - Sandover Architects Chris Chee 9225 0600	Level 3 Conventional
20/06/2012	Yanchep Police Station	Transportable Police Station & complete site works	\$1,361,355	20 Weeks	DoF - WA Police - Oldfield Knott Architects Mike West 9381 6788	Level 3 Conventional
7/06/2012	Marble Bar Police Station upgrade	Transportable Cell & charge dock - Design, Manufacture & Install	\$1,028,406	20 Weeks	DoF - WA Police - Hoffman Architects Gordon Purvis 9380 4150	Level 1 Conventional
7/06/2012	Tom Price Motel Units	Motel Units & site works - Design & Construct, Manufacture & Install	\$567,450		RAMINEA PTY LTD	Private Project



Building Projects

Company Name - Quality Builders Pty Ltd		Completed Projects June 2011 - Sept. 2020				
Project Completion Date	Project Name.	Type of Works	Project Value Inc. GST	Construction Period	Client/Reference	Facility Complexity
6/06/2012	Water Treatment Facility	Transportable Pump House - Design & Construct, Manufacture	\$99,368		Comdrain - Doric	N/A
28/05/2012	St.Ives Goldmine Agro Changeroom Building	Transportable offices, changerroom, shower & toilet facility - Design & Manufacture	\$765,696	12 Weeks	Alco Building Company - St Ives Gold Mining	Private Project
27/05/2012	Two Metalwork, Design and Technology Classrooms and Three Science Labs	Transportable Metalwork & Science Classrooms - Design & Manufacture	\$1,746,480	20 Weeks	DoF - Dept. of Education - Parry & Whyte Architects Alec Whyte 9388 1139	Level 2 Conventional
16/03/2012	Weerianna Reunification Transportable	Transportable Short Stay Accommodation - Design, Manufacture & Install	\$245,690	20 Weeks	DoF - Dept. of Child Protection Hart Architects Kenny Chan Lun 9322 1122	Minor Works
25/02/2012	New Genes for New Enviroments Facility Katanning	Transportable Agriculture Laboratory - Design, Manufacture & Install	\$870,590	16 Weeks	DoF - Dept of Ag. & Food GHD Architects Gary Townsend 6222 8907	Level 1 Simple
23/12/2011	Grenough Childcare Centre	Transportable Creche including Disabled Bathroom - Design, Manufacture & Install	\$158,070		City of Geraldton-Greenough	N/A
5/12/2011	Transportable Toilet Blocks	9 x Toilet blocks for multiple remote locations - Design & Manufacture	\$1,092,086	22 Weeks	DoF - Dept. of Education - Parry & Whyte Architects. Alec Whyte 9388 1139	Level 2 Conventional
25/11/2011	New Genes for New Enviroments Facility Merreden	Transportable Agriculture Laboratory - Design, Manufacture & Install	\$902,759	12 Weeks	DoF - Dept of Ag. & Food GHD Architects Gary Townsend 6222 8907	Level 1 Conventional
12/10/2011	Transportable Library Buildings	2 x Double Library transportable buildings - Design & Manufacture	\$570,125	16 Weeks	DoF - Dept. of Ed - Parry & Rossenthal Architects - Wai Kin 9481 0540	Level 1 Simple
22/09/2011	Highgate Police Station WC	Transportable Toilet block for Highgate PS - Design, Manufacture & Install	\$76,923		DoF - Highgate Police Historical Society Philip Griffiths Architects	Minor Works
19/08/2011	Warburton Work Camp -	Multiple transportable buildings & complete site works - Design, Manufacture & Install	\$11,636,526	24 Weeks	DoF - Corrective Services. COX Architects - Mark Hainsworth 9322 3644	Level 4 Conventional
22/06/2011	Jeramungup Police Station	Transportable Police Station & complete site works	\$1,465,184	25 Weeks	DoF - WA Police -Hartree Architects Matt Wellinger 9481 7119	Level 3 Coventional
1/06/2011	St.Josephs & St. Mary Catholic Schools	School addition & Library - Design & Construct, Manufacture & Install	\$1,940,462	48 Weeks	Catholic Education - Santelli Architects Andrew Myers 9328 3711	N/A

## 10 TENDERER'S RESOURCES SCHEDULE

### 10.1 TENDERER'S CURRENT COMMITMENT SCHEDULE

Project	Description	Value as Let	Date Started	Date Completed/ Anticipated Date of Practical Completion
	** SEE ATTACHED**			

### 10.2 TENDERER'S HUMAN RESOURCES SCHEDULE

Staff Name	Month	Month	Month
** SEE ATTACHED**			

## Tenders Current Commitment Schedule

Current Projects - Quality Builders Pty Ltd		Project Staff		Project No.	Project Value Ex. GST	Project Duration (Commencement and Completion Dates)	Status of Works (ie. Tendered For or Current)	DATE	Sept. 2020	Percentage of Capacity Represented
Project Name, Type of Works								Percentage of Current workload Represented	Percentage of Current Works completed	
Supply and Installation of a 2x1 Bedroom Modular House in Burringurrah Remote Community	Nigel Barr	HOU9608720	\$ 283,755.00	17.07/20-22.01/21	Current		5%	50%	1%	
Transportables 2020 Mid-Year Program - Package 3 - 15x GLA, 5x UAT	Jason Hitchins, Roddy Cameron	BMW0302520	\$ 2,083,181.80	19.08/20-9.01/21	Current		35%	45%	9%	
Transportables 2020 Mid-Year Program - Package 2 - 10x GLA, 5x Toilet Blocks	Jason Hitchins, Roddy Cameron	BMW0302820	\$ 1,613,061.72	19.08/20-9.01/21	Current		27%	45%	7%	
Transportables 2020 Mid-Year Program - Package 1 - 10x GLA, 5x ECE	Jason Hitchins, Roddy Cameron	BMW0302220	\$ 2,024,628.00	19.08.20-23.01.21	Current		34%	45%	8%	
TOTAL CONTRACTS VALUE			\$ 6,004,627							
Capacity			\$ 24,000,000							
TOTAL CAPACITY REPRESENTED			25%							



**APPENDIX D -  
Personnel & Skills**

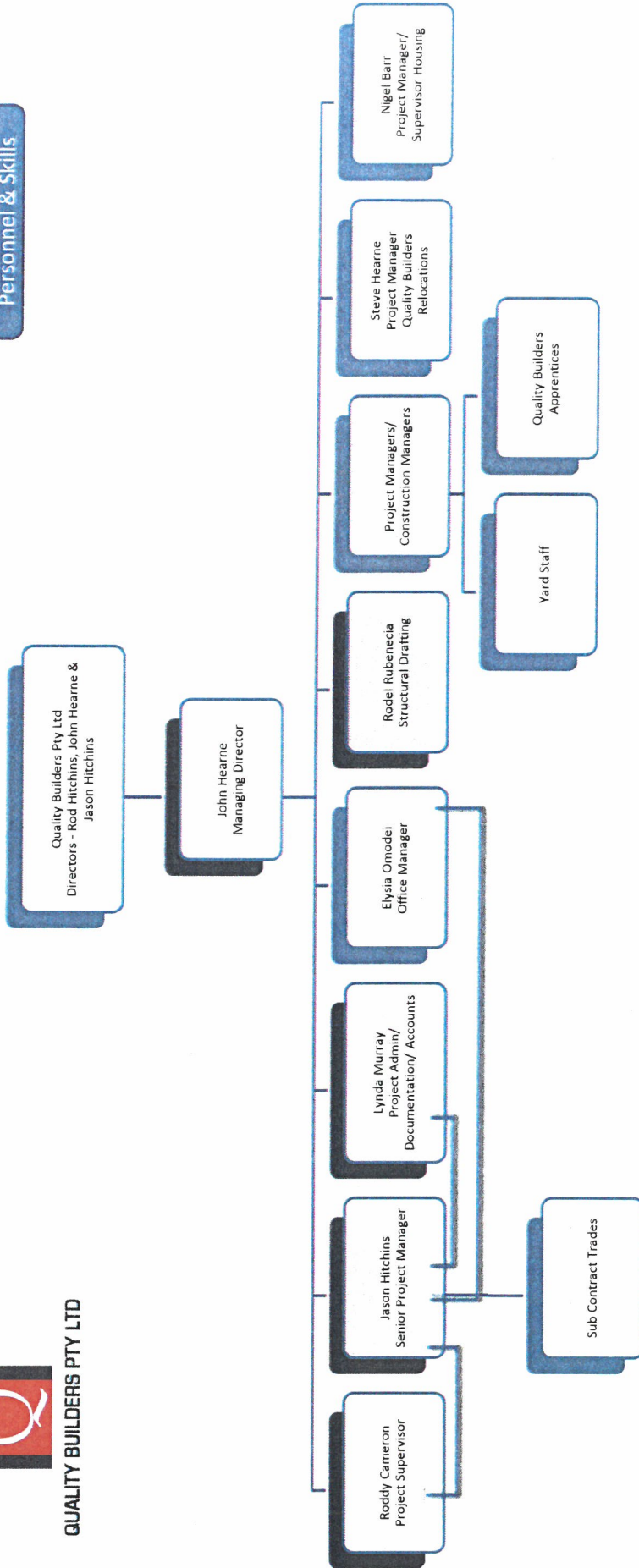



ASIC

Australian Securities & Investments Commission

Australian Company

QUALITY BUILDERS PTY. LTD.

ACN 009 129 677

Extracted from ASIC's database at AEST 17:52:50 on 03/11/2020

### Company Summary

Name: QUALITY BUILDERS PTY. LTD.

ACN: 009 129 677

ABN: 80 009 129 677

Previous State Number: C0811683K

Previous State of Registration: Western Australia

Registration Date: 23/04/1985

Next Review Date: 23/04/2021

Status: Registered

Type: Australian Proprietary Company, Limited By Shares

Locality of Registered Office: PERTH WA 6000

Regulator: Australian Securities & Investments Commission

Further information relating to this organisation may be purchased from ASIC.

# Referees

Adrian Iredale – Iredale Pederson Hooke Architects

- Email - [i@iredalepedersenhook.com](mailto:i@iredalepedersenhook.com)
- Ph. 9322 9750
- Projects:
  - Multiple Dept. of Education Projects. GLA Classrooms, Pre-Primary Classrooms, Technology Classrooms, Science Classrooms etc.
  - Harrisdale SHS – Two story modular classrooms & site access.

Bill Boehm – CEO Murchison Shire

- Email - [ceo@murchison.wa.gov.au](mailto:ceo@murchison.wa.gov.au)
- Ph. 9963 7999
- Projects:
  - 1 x 4Bed/2Bath modular home & site works
  - 1 x 3Bed/2bath modular home & site works
  - 1 x Bathroom renovation to CEO house.

Lana Foote - Manager of Finance and Administration Shire of Koorda

- Email - [dceo@koorda.wa.gov.au](mailto:dceo@koorda.wa.gov.au)
- Ph. 9684 1219
- Project:
  - 1 x 3Bed/2bath modular home & site works.

Mark Ainslie - Griffin Infrastructure & Resources

- Ph. 0409 009 505
- Projects:
  - Multiple Dept.of Housing modular housing projects from 2012 - 2019

# Subcontractors

## **Fault Finders (WA) Pty Ltd**

- Electrical Works
- A&S Hill Electricians
- E.C. 007739
- P.O. BOX 174 WALLISTON DC WA 6925
- E: [hillenergy@bigpond.com](mailto:hillenergy@bigpond.com)
- Ph: (08) 9454 3055
- Fax: (08) 9454 3066
- Mob: 0417 914 143
- No. of Employees – 10

## **High Wycombe Plumbing & Gas**

- Plumbing Works
- 3/1124 Abernethy Road High Wycombe 6057
- Mobile: 0418 914 686
- Email: [graeme@hwplumbing.com.au](mailto:graeme@hwplumbing.com.au)
- No. of Employees – 4

# FINACIAL POSITION

Quality Builders Pty Ltd acts as trustee for the Quality Builders Unit Trust.

The Company structure currently has 3 directors (D) & 3 unit holders(UH), Rod Hitchins (D,UH), John Hearne (D, UH) & Jason Hitchins (D, UH).

- D – Director
- UH – Unit Holder

To ensure the viability of the company the unit holders of Quality Builders have an overdraft facility of \$0.75m and a bank guarantee facility of \$3.0m, and a \$1.0m external funding option.

Should Quality Builders be considered as a preferred tenderer for this project we will provide our profit & loss statement and the most recent financial reports.



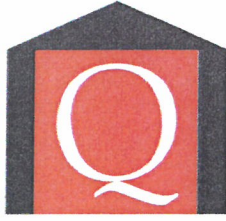

20 Walters Way Forrestfield WA 6058  
PO Box 303 Kalamunda WA 6926  
Ph: 9454 9700 Fax: 9454 9711  
ABN: 51 881 383 907

## QUALITY BUILDERS PTY LTD

### RELEVANT EXPERIENCE

- i) Quality Builders has been involved with the construction of dwellings for DoH & Shires for 15 plus years. We have constructed homes in various locations throughout Western Australia, many in remote areas with little or no services in the towns & communities.

We have a history of providing a quality product that meets/exceeds the expectation & budgets of DoH and their clients.

Some of the Dept of Housing & Shire projects are as follows:

- HOU 2012/16553 - 5 Houses Port Hedland.
- HOU 9623912 - 3 Houses Useless Loop.
- HOU 96653/2012 - 5 Houses Port Hedland.
- HOU 96301/2013 - 1 House - Pia Wadjari Aboriginal Community.
- HOU 96302/2013 - 1 House Yulga Jinna Aboriginal Community.
- HOU 9612814 – 2 Houses Eucla.
- HOU9616314 – 6 Houses Mullewa.
- HOU9618714 – 3 Houses Paraburdoo.
- RFT 2015-05065 – 4 Houses Wickham
- HOU9615815 - 1 House Salmon Gums
- HOU9633215 - 1 House Laverton
- HOU9630715 - 1 House Mt.Magnet
- HOU9616415 - 1 House Norseman
- HOU9623216 - 2 Houses Corrigin
- HOU9604416 - Exmouth x 20 Houses including 2 Storey Dwellings
- HOU9625716 - 1 House Koorda
- HOU9625816 - 1 House Paraburdoo
- HOU6902517 - 2 Houses Mt. Margaret
- HOU6902217 - 1 House Cue
- Shire of Pingelly – 5 x Age Appropriate Accommodation
- HOU6903517 - 1 House Merredin
- HOU6906817 - 3 Houses Meekatharra
- HOU9607417 - 1 House Narrogin
- HOU9613619 – 1 x House Eucla
- Shire of Murchison – 2 Houses Murchison Settlement

Attached is a list of completed works, and current projects.

**ii) Project Issue Examples**

**1. HOU6902517 - 2 Houses Mt. Margaret**

Post tender advice Dept.of Housing advised that GROH required enclosed garages instead of open carports. QB was able to redesign the existing dwellings, on an already restricted site and accommodate the GROH requirements, these last minute changes had not effect on construction program or project outcome.

Following a site inspection, prior to delivery of transportable dwelling, there was discovery of a significant amount of sub-surface rock. It was decided to raise the building to mitigate rock excavation. QB coordinated additional clean fill to raise the site without impacting other aspects of the site including site plumbing & electrical, and impeding the pending delivery of the transportable dwellings

**2. HOU6906817 - 3 Houses Meekatharra**

Following a site inspection, prior to delivery of transportable dwelling, there was discovery of a significant amount of sub-surface redundant septic system & building footings & structure that weren't identified in the tender survey. With coordination of QB's civil contractor the redundant items were removed and the additional clean fill brought in & compacted. These last minute works were completed without impacting the pending delivery of the transportable dwellings and other aspects of the site including site plumbing & electrical.

- iii)** Whilst the construction of the transportable dwelling will be a key factor, QB's history & experience indicate this will not be an overriding consideration. We have regular available trades & in house structural fabrication which allows immediate start on construction.

The key elements of this project will be the coordination & completion of the site works. As this project is in a remote location, the coordination of site civil works, hydraulics, electrical and concrete works will be paramount to the completion of the works. The contractors completing these works have completed several projects for QB and have a full understanding of the coordination & completion of the works.

Quality Builders only employ/engage metro based trades, services & suppliers for Perth based works, and seek Regional suppliers & contractors for regional works were applicable and cost effective. We have long term suppliers & contractors that we work closely with for implementing new products, work methods and best practice that improve the long term opportunities for our Metro & Regional suppliers & contractors.

We actively employ between 4 to 6 apprentices and work with local schools, SMYL and Trade Colleges to provide work experience opportunities. This has been beneficial for QB and local youth with several work experience students being offered apprenticeships with QB. Our apprenticeship/work experience model has seen over completion of over 30 employees complete their apprenticeship, and additional to this success we have 5 off those apprentices working for QB as tradesmen, and several others working for other modular building companies.

We don't seek foreign suppliers of goods or services so this has no competitive effect on the local suppliers of goods or services that we use.

Please see attached our Aboriginal Employment Plan.

We have established long standing relationships with many architects, consultants and project managers, and provide the following as referees:

- Adrian Iredale – Iredale Pederson Hook Architects.
- Bill Boehm – CEO Murchison Shire
- Lana Foote - Manager of Finance and Administration Shire of Koorda
- Mark Ainslie - Griffin Infrastructure & Resources
- Alec Whyte – Parry & White Architects
- Paul Rossen – Parry & Rosenthal Architects
- Rob Martin – Priden Homes
- Peter Haxby - HRD Construction Management
- Adam Lucas – AJL Consulting

## **CAPABILITY AND METHODOLOGY**

### **i) Project Timeline**

Should Quality Builders be successful we have sufficient yard space to commence the construction immediately. We have our own fabrication workshop for wall & roof frame fabrication and also structural steel fabrication.

We envisage a 20 week in yard construction for the dwelling & delivery to site program. Deliver to site will be dependent on granting of site possession.

Once the building has been sited the remaining site works and construction of the alfresco, carport, verandahs & service connections will be 6 weeks. This will make the total construction program of 26 weeks.

Quality Builders has a proven track record for delivering projects on time for our clients.

## ii) Methodology

### In-Yard Construction

- Contract Award.
- Complete Preliminary items – Insurance, BCTIF, Bank Guarantees etc.
- Complete shop drawings & services drawings for Superintendents review.
- Order pre-stressed concrete floors.
- Order Structural steel & wall/roof frame material.
- Place all orders for building components, deliveries staged to match works program.
- Fabricate structural steel components for yard & site construction (priority for wall frame structural components).
- Fabricate wall frames & roof frame.
- Complex floor base, wall, roof & ceiling frame.
- Services (Mechanical, Hydraulic & Elect) preliminary install.
- Commence install of external cladding (roof & wall).
- Commence install of internal linings.
- Painting to internal walls.
- Install cabinets & benching
- Commence Carpentry 2<sup>nd</sup> fix items.
- Painting to 2<sup>nd</sup> fix items.
- Complete Services (Mechanical, Hydraulic & Elect) final install.
- Install floor coverings.
- Commence Carpentry hardware fit off.
- Installation fixtures, window treatments and signage.
- Pre PC inspection coordinated for the completion of buildings.
- Final touch-ups completed for buildings, as per Pre PC inspections.
- Final PC as per program requirements of buildings as per specification.
- Prepare & arrange transport of buildings to site.

### Building Construction Site Works and Complexing Building:

- Design & detail footings following soil classification report.
- Commence site civil/earth works (clearing & site preparation)

- Prepare box out & levels for building area.
- Survey, establish datum point & set out point.
- Finalise levels. Set-out, dig & pour footings (if required)
- Set-up temporary power supply.
- Transport building units to site, install & complex to weatherproof building.
- Transport material for site works.
- Commence construction/erecting of site structures.
- Commence Electrical, Hydraulic
- Complex & Connection of Services to building.
- Commence concrete paving
- Completion & Commission Electrical, Hydraulics & Mechanical.
- Finalise painting, internal & external.
- Carry out Pre-PC inspection.
- Complete Final touch-up and snag list.
- Final PC as per program and arrange handover of building.

Should the award be late in December 2019 then an additional 2 weeks may be required to accommodate the Christmas period due to the delay in supply of critical material components.

### **Occupational Health & Safety**

Our Workplace Health and Safety Policy is based on a belief that the well-being of people employed at work, or people affected by our work, is a major priority and must be considered.

People are our most important asset and health and safety in the workplace is everyone's responsibility with every person being of equal priority, including members of the public.

The objectives of our Safety Policy are to ensure all measures are taken, so far as is reasonably practicable, to:

- Strive to achieve a safe workplace.
- Consider health and safety in project planning and work activities.
- Involve our employees and contractors in the decision-making processes through regular communication, consultation and training.

- Encourage employees and contractors to undertake a continuous program of education and learning to identify and control hazards in the workplace through a continuous risk management program.
- Take action to eliminate or control potential accidents/incidents.
- Provide effective injury management and rehabilitation for all employees.

The success of our health and safety management depends on:

- Planning of work activities with due consideration given to implementing OH&S controls that are suitable to each given situation.
- Understanding the total work process and associated OH&S risks.
- Encouraging the work team to be committed to achieving our objectives.
- Encouraging open and honest communication between our employees and all subcontractors.

Quality Builders has had no prosecutions by Worksafe over the past 9 years.

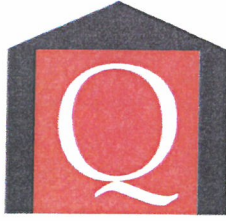

20 Walters Way Forrestfield WA 6058  
PO Box 303 Kalamunda WA 6926  
Ph: 9454 9700 Fax: 9454 9711  
ABN: 51 881 383 907

## QUALITY BUILDERS PTY LTD

### TENDERER'S RESOURCES

#### ORGANISATIONAL CAPACITY AND PERSONNEL

i) The following personnel will be involved in the construction of this project:

- Project Manager/Supervisor – Nigel Bar (CV attached).
- Supervisor – Roddy Cameron (CV attached).
- Contract Manager – John Hearne (CV attached).
- Design/Structural Draftsmen - Rodel Rubenecia (CV Attached).

Nigel Barr will head the project, however should the need arise, Jason Hitchins or Steve Hearne have the experience to manage the project in the interim.

ii) The following subcontractors will be utilised on this project:

- Electrical & Mechanical- Fault Finders
- Plumbing – High Wycombe Plumbing & Gas
- Painting – Pentland Painting & Decorating
- Carpentry- Handgraaf Carpentry
- Internal linings – JACs Ceilings
- Tiling – SD Tiling
- Cabinets & Joinery – Curfew Cabinets
- Structural Steel Fabrication – Alex Geranis Welding
- Transport – Universal Transport
- Site Concrete & finishing– Royalle Concrete Services
- Mechanical – Blair Air

Our trades along with Quality Buildings have continually shown we have the capacity to undertake works of this nature.

#### **Plant & Equipment**

Quality Builders have our own 8 tonne tipper truck, 5 tonne tipper truck & 2 x skid steer bobcat with a variety of plant attachments and 3 x Utility vehicles & 3 x box trailers which will can utilised on this project.

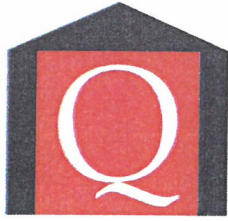

20 Walters Way Forrestfield WA 6058  
PO Box 303 Kalamunda WA 6926  
Ph: 9454 9700 Fax: 9454 9711

ABN: 51 881 383 907

## QUALITY BUILDERS PTY LTD

6 November 2020

Shire of Wickepin  
77 Wogolin Rd  
WICKEPIN WA 6370

**RE: RFT 3 2020/2021 Design & Construction of 4 Bed/2 Bath Dwelling for Shire of Wickepin**

Dear Sir/Madam,

### **ITEMS & FEATURES OF THESE HOUSES INCLUDED ARE AS FOLLOWS:**

- Transportable house construction to Region A.
- Pre-stressed concrete floors on concrete 600mm dia. X 150mm pre-cast footings to suite 'A or S' Class soil classification.
- Kordon termite protection to walls.
- Energy efficiency to a minimum 6-star rating.
- BlueScope Truecore **2.7m high steel wall frames** and steel roof trusses.
- Roof covered with Colorbond Custom Orb sheeting with R 1.3 anticon.
- External walls clad in Colorbond Custom Orb sheeting (horizontal), as shown on elevations.
- External feature walls clad with Hardies Weatherboard sheeting, as shown on elevations.
- External walls sarked with double sided sisalation and thermal break.
- Insulation - R 2.0 Bradford batts to the external walls.
- Insulation - R 3.0 Bradford batts to the entire ceiling area.
- Insulation - R 1.5 Bradford batts to the internal walls.
- Eaves and verges lined with Hardiflex.
- Internal walls lined with flush jointed 10mm Gyprock.
- Internal ceilings lined with flush jointed 10mm Gyprock.
- Fully painted internally and externally in your selection of colours.(Two colours internally)
- Jason "Keylock" windows & door, powdercoat coloured aluminium sliding (Choice of seven colours) including flyscreens, with painted steel window reveals.
- Security screen to opening sash of bedroom windows.



- Sliding and hinged external doors fitted with heavy duty security door. (No Security door to store).
- External door flush panel solid core painted in gloss enamel.
- Internal doors flush panel hollow core painted in gloss enamel.
- Internal doors to wet areas flush panel moisture resistant hollow core painted in gloss enamel.
- Painted split steel door frames internally with skirtings to be painted custom wood.
- Kitchen cupboards as shown on plan, melamine internally and with laminated postform tops and fronts to your colour choice.
- Vanity cupboards as shown on plan, melamine internally and with laminated postform tops and fronts to your colour choice.
- Robes with sliding doors & internal shelving.
- Wired for AC power with adequate LED light, power points, phone points and TV points (Foxtel ready) as per electrical plan. , Exhaust Fans to bathroom and toilet. Sweep fans throughout.
- Copper tube water pipes concealed in walls connecting to a 20mm Mains line.
- Shower screen with pivot door.
- Stainless steel double bowl inset sink with flick mixer.
- Laundry inset trough 45 litre stainless steel with suds saver and cupboards with lockable door catch as per plans.
- 270ltr Evo heat pump hot water unit has been included. Reverse cycle split air conditioners units (as shown on plan).
- Westinghouse Electric under bench oven and Gas hotplate with range hood above.
- Westinghouse 600mm dishwasher.
- Vertical blinds to all windows except WC, bathroom and ensuite.
- Ceramic Floor / Wall Tiles
  - Kitchen Two rows over kitchen benches
  - Bath/Ensuite/Toilet One row of skirting tiles with 200mm x 200mm floor tiles.
  - Showers 2000mm high
  - Entry/Porch 300 x 300/400x400 Floor tiles
- Verandah and Alfresco all duragal steel with powdercoated beams and posts.
- Concrete to verandah, alfresco and pathways, as shown on site plan.
- Double lock-up Garage on 100mm reinforced concrete floor with edge thickening, steel wall frames and steel roof trusses, externally clad (as shown on plans), 6.0mm FCS lining to internal walls & ceilings and automated Colorbond Sectional Door. PA door, location can be changed to suit client requirements.
- Shed 10.0m x 7.0m on 100mm reinforced concrete floor with edge thickening, steel wall frames and steel roof trusses, externally clad (as shown on plans), and Colorbond Roller Door. PA door, location can be changed to suit client requirements.
- Earthworks – Site clear, cut & fill.
- Site plumbing – Including deep sewer & mains connection.
- Stormwater connection
- Site electrical works and Telstra connection. Electrical mains power connection from the Electrical Supply Network Authority underground power to dwelling has been included & phone connection, providing Telstra infrastructure is in place.
- Hills Supa Fold clothes line.
- Heavy Duty carpet on 10mm underlay as shown on plans as per specification or of similar quality.
- Vinyl floor tiles as shown on plans, as per specification or of similar quality.

We have not allowed for the following:

- Turboflow water softener.
- Rock excavation and removal & clean fill replacement

I trust the above meets with your approval. If you require any additional information, please do not hesitate in contacting me.

Yours Faithfully,

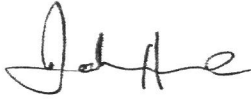
A handwritten signature in black ink, appearing to read 'John Hearne', written in a cursive style.

John Hearne  
**Managing Director**

**GENERAL NOTES:**

- DO NOT SCALE FROM THIS DRAWING. ALL CONTRACTORS TO CHECK DIMENSIONS AND NOTES PRIOR TO COMMENCEMENT OF ANY WORKS AND ANY DISCREPANCIES TO BE NOTIFIED TO THE SITE SUPERVISOR WITHOUT DELAY.
- DIMENSIONS SHOWN ON THIS PLAN ARE TO STEEL FRAME AND DOES NOT INCLUDE EXTERNAL CLADDING OR INTERNAL LINING WIDTH.

**CLIENT NOTE:**

READ IN CONJUNCTION WITH ADDENDA

**INTERNAL OPENINGS:**

DHO: DOOR HEIGHT OPENING 2040mm A.F.L. UNLESS OTHERWISE NOTED.

**ABBREVIATION LEGEND**

A/C	AIR CONDITIONING UNIT - SPLIT TYPE
COND	A/C CONDENSER - EXTERNAL UNIT
RH	RANGEHOOD
UBO	UNDERBENCH OVEN
FR/FZ	FRIDGE / FREEZER RECESS
DW	DISHWASHER RECESS
HP	HEAT PUMP
WM	WASHING MACHINE RECESS
TRH	TOILET ROLL HOLDER
DTR	DOUBLE TOWEL RAIL
TRG	TOWEL RING
MH	MANHOLE
BRM	BROOM
OBS	OBSCURE
FT	FRIDGE TAP
HC	HOSE COCK

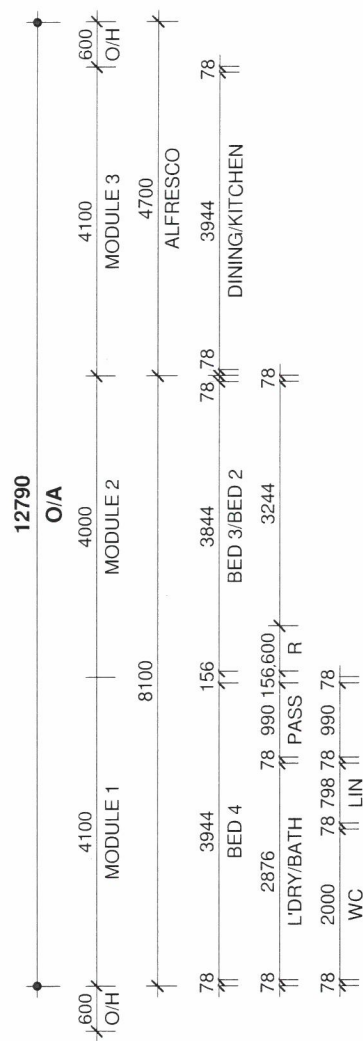

**AREAS:**

HOUSE:	173.98m <sup>2</sup>
GARAGE:	39.04m <sup>2</sup>
ALFRESCO:	25.38m <sup>2</sup>
VERANDAH:	25.35m <sup>2</sup>
<b>TOTAL AREA:</b>	<b>263.75m<sup>2</sup></b>

**1 FLOOR PLAN**  
1 : 100

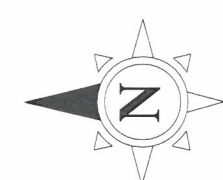
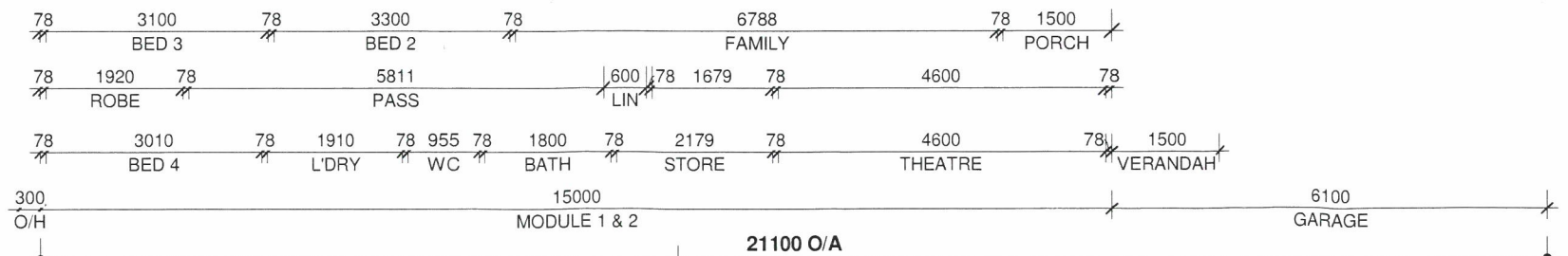
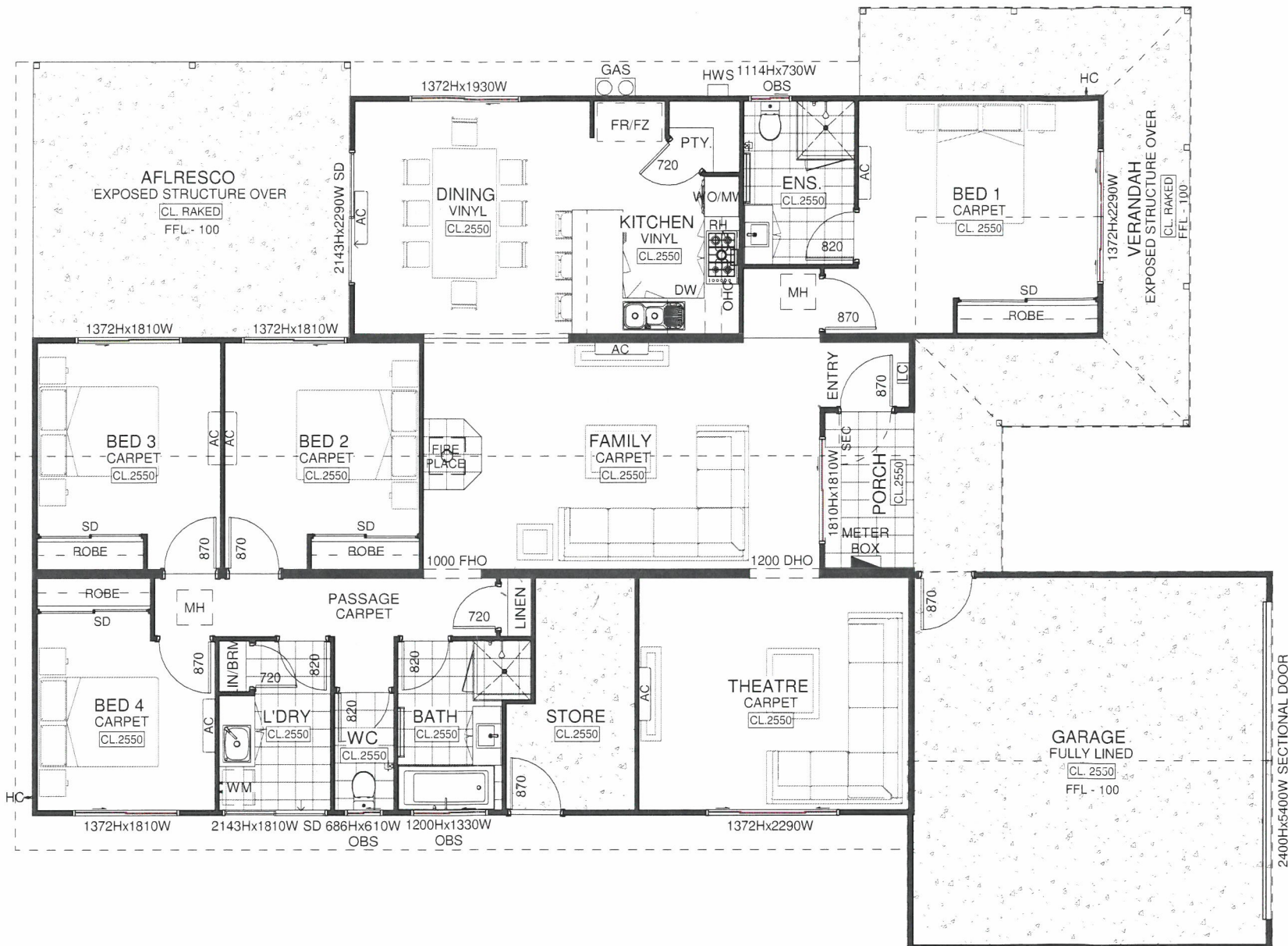
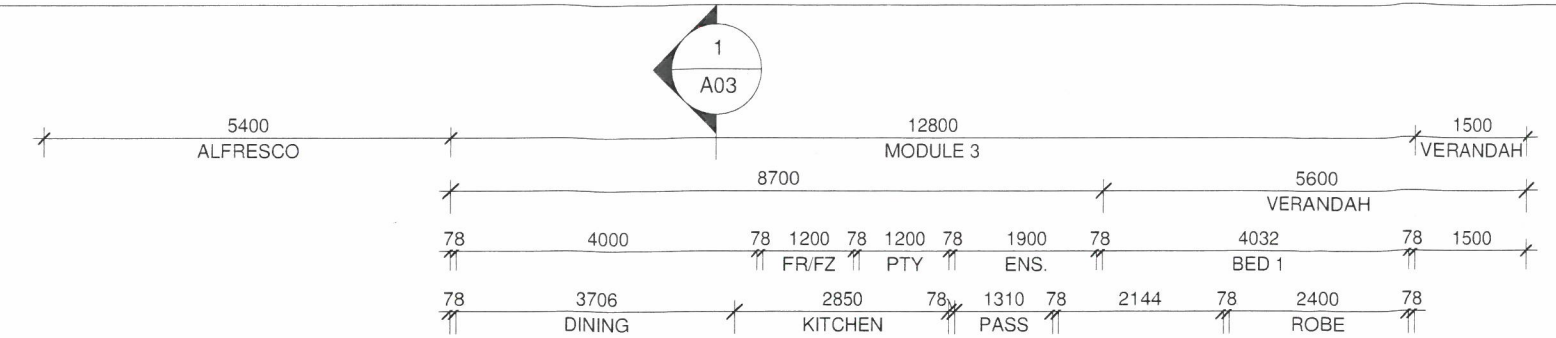

E1 A02

E2

E4 A-J2 E3

**TENDER DRAWINGS**

Copyright: This document is and shall remain the property of Quality Builders PTY LTD ©

**QUALITY BUILDERS**  
A Division Of Quality Builders  
PO Box 303, Kalamunda WA 6926  
(08) 9454 9522  
www.qualitybuilders.com.au

A	PREPARE TENDER DRAWINGS	RIR	21/10/2020
ISSUE	AMENDMENT	BY	DATE

**SHEET CONTENT:**

**FLOOR PLAN**

DATE:	15/10/2020
DRAWN BY:	RIR
CHECKED BY:	JH
SCALE:	1 : 100

PROPOSED RESIDENCE FOR

**4 BED+ 2 BATH**  
**LOT 50 SMITH STREET,**  
**WICKEPIN WA 6370**

PROJECT NO.	QBB373
DWG. NO.	A01
REV.	A

O:\Drawing\2020\Quality Builders\QB373 - Wickepin House 4+2 Enclosure\QB373 - Wickepin 4+2 Enclosure House.rvt

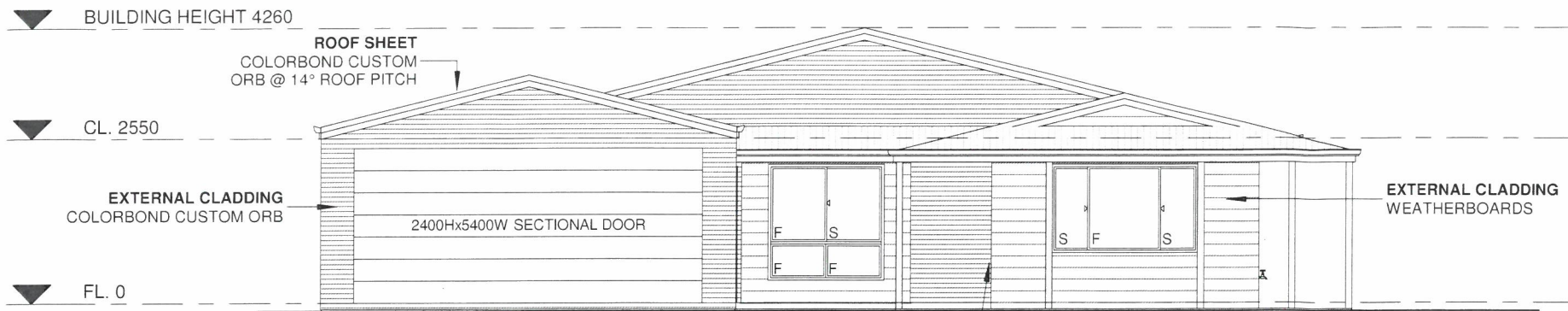

**E1 ELEVATION**  
A02 1 : 100

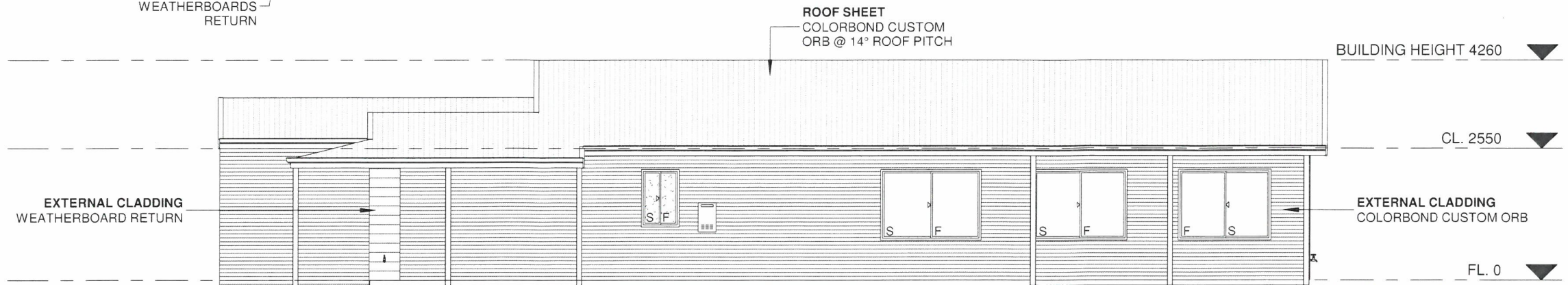

**E2 ELEVATION**  
A02 1 : 100

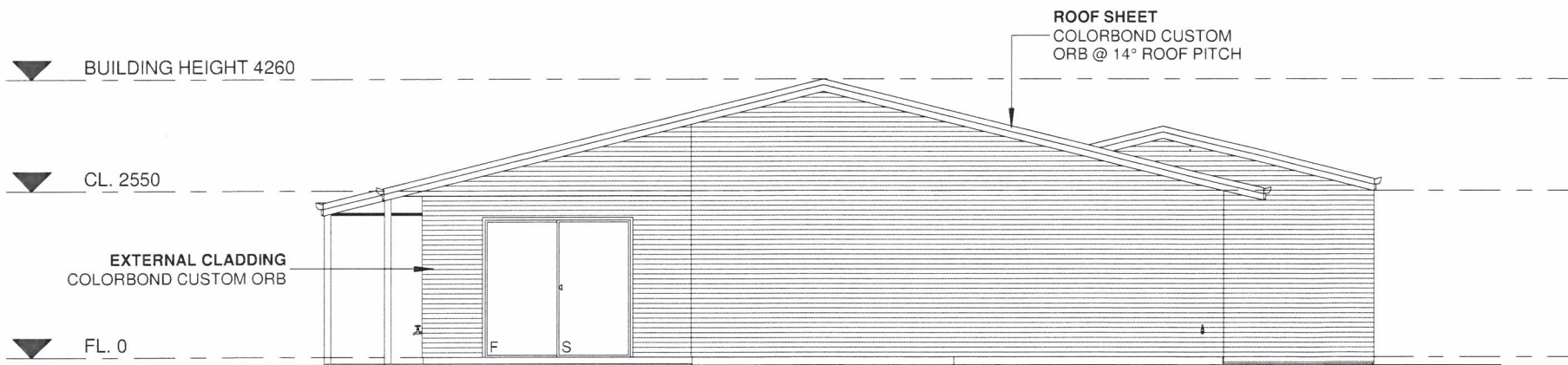

**E3 ELEVATION**  
A02 1 : 100

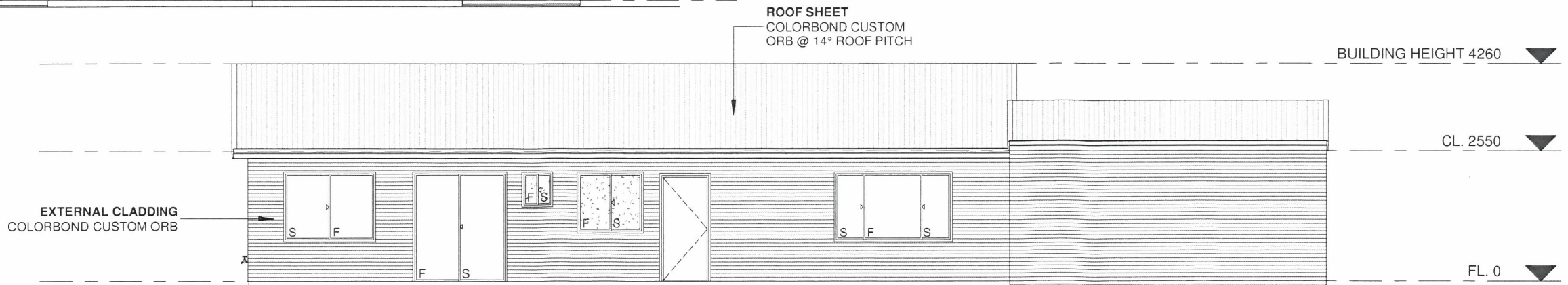

**E4 ELEVATION**  
A02 1 : 100

**TENDER DRAWINGS**

Copyright. This document is and shall remain the property of Quality Builders PTY LTD ©

**QUALITY BUILDERS**  
A Division Of Quality Builders  
PO Box 303, Kalamunda WA 6926  
(08) 9454 9522  
[www.qualitybuilders.com.au](http://www.qualitybuilders.com.au)

A	PREPARE TENDER DRAWINGS	RIR	21/10/2020
ISSUE	AMENDMENT	BY	DATE

SHEET CONTENT:		
<b>ELEVATIONS</b>		
DATE:	DRAWN BY:	CHECKED BY:
15/10/2020	RIR	JH
SCALE:	1 : 100	<b>A3</b>

PROPOSED RESIDENCE FOR		
4 BED+ 2 BATH		
LOT 50 SMITH STREET, WICKEPIN WA 6370		
PROJECT NO.	DWG. NO.	REV.
QBQ373	A02	A

O: Drawing 2020 Quality Builders QBQ373 Wickepin House 42 Executive QBQ373 Wickepin 42 Executive House.rvt

# ELECTRICAL LEGEND

	LED GLOBE LIGHT FITTINGS
	DOUBLE BATTEN ROUND FLURO LIGHT
	DOWNLIGHT - LED, LOW VOLTAGE
	LIGHT MOTION SENSOR
EF	WALL MOUNTED EXHAUST FAN
	LED OYSTER LIGHT
	DOUBLE BATTEN FLURO LIGHT FITTINGS
	EXHAUST FAN/HEAT/LIGHT COMBO - CEILING MOUNTED
	BATTEN - WALL MOUNTED @ 1900 A.F.L. UNLESS OTHERWISE NOTED
	LIGHT SENSOR
	SINGLE GPO @ 250 A.F.L. UNLESS OTHERWISE NOTED
	SINGLE GPO, CEILING MOUNTED
	DOUBLE GPO @ 250 A.F.L. UNLESS OTHERWISE NOTED
	WEATHERPROOF SINGLE GPO @ 1050 A.F.L. UNLESS OTHERWISE NOTED
	WEATHERPROOF DOUBLE GPO @ 1050 A.F.L. UNLESS OTHERWISE NOTED
	DIGITAL DATA / TELEPHONE POINT
	TV ANTENNA POINT
	LIGHT SWITCH
	SOLAR HWS BOOSTER SWITCH
	HARDWIRED SMOKE DETECTOR c/w BATTERY BACKUP
	CEILING SWEEP FAN 1400mm UNLESS OTHERWISE NOTED
	LED LIGHT / CEILING SWEEP FAN 1400mm UNLESS OTHERWISE NOTED
AC	SPLIT TYPE INVERTED AIR CONDITIONING UNIT
COND	SPLIT TYPE AIR CONDITIONER EXTERNAL CONDENSER UNIT
	WALL MOUNTED EXHAUST FAN, LOCATED CENTRALLY ABOVE WINDOW
	TUNDISH AND GRATED FLOOR WASTE (TYPICAL)
LC	LOAD CENTRE
	METER BOX

## ELECTRICAL NOTES:

1. ALL ELECTRICAL HEIGHTS ARE MEASURED FROM FINISHED FLOOR LEVEL
2. ALL LIGHT SWITCHES TO BE 1200HT ABOVE FINISHED FLOOR LEVEL UNLESS OTHERWISE NOTED
3. EXTERNAL LIGHT FITTINGS TO BE 1900 HT ABOVE FINISHED FLOOR LEVEL - MEASURED TO UNDERSIDE OF FITTING

## MECHANICAL NOTE:

- ALL DRAINS TO BE INSULATED AND DISCHARGED TO A TUNDISH AND GRATED FLOOR WASTE.
- FLOOR WASTE TO BE MINIMUM OF 1.0m FROM FOOTINGS.
- ALL ELECTRICAL WORK TO COMPLY WITH AS 3000.
- REFRIGERATION PIPING TO BE AS REQUIRED BY MANUFACTURER.
- REFRIGERATION PIPE INSULATION TO BE 12mm WALL THICK.
- OUTDOOR UNITS FRAMES TO BE HOT DIPPED GALVANIZED WITH DOUBLE DEFLECTION VIBRATION ISOLATING MOUNTS.
- UNDERSIDE OF EXTERNAL UNITS TO BE 100mm ABOVE F.F.L.
- ISOLATION SWITCH TO INTERNAL SPLIT UNIT TO BE 20AMP.
- ISOLATION SWITCH TO EXTERNAL CASSETTE UNIT TO BE 40AMP.
- CIRCUIT BREAKERS TO SUIT LOAD REQUIREMENTS FOR INDIVIDUAL UNITS.

## AIR CONDITIONING UNIT SCHEDULE:

FAMILY ROOM:	5.0Kw
THEATRE/DINING:	3.5Kw
BEDROOMS:	2.5Kw

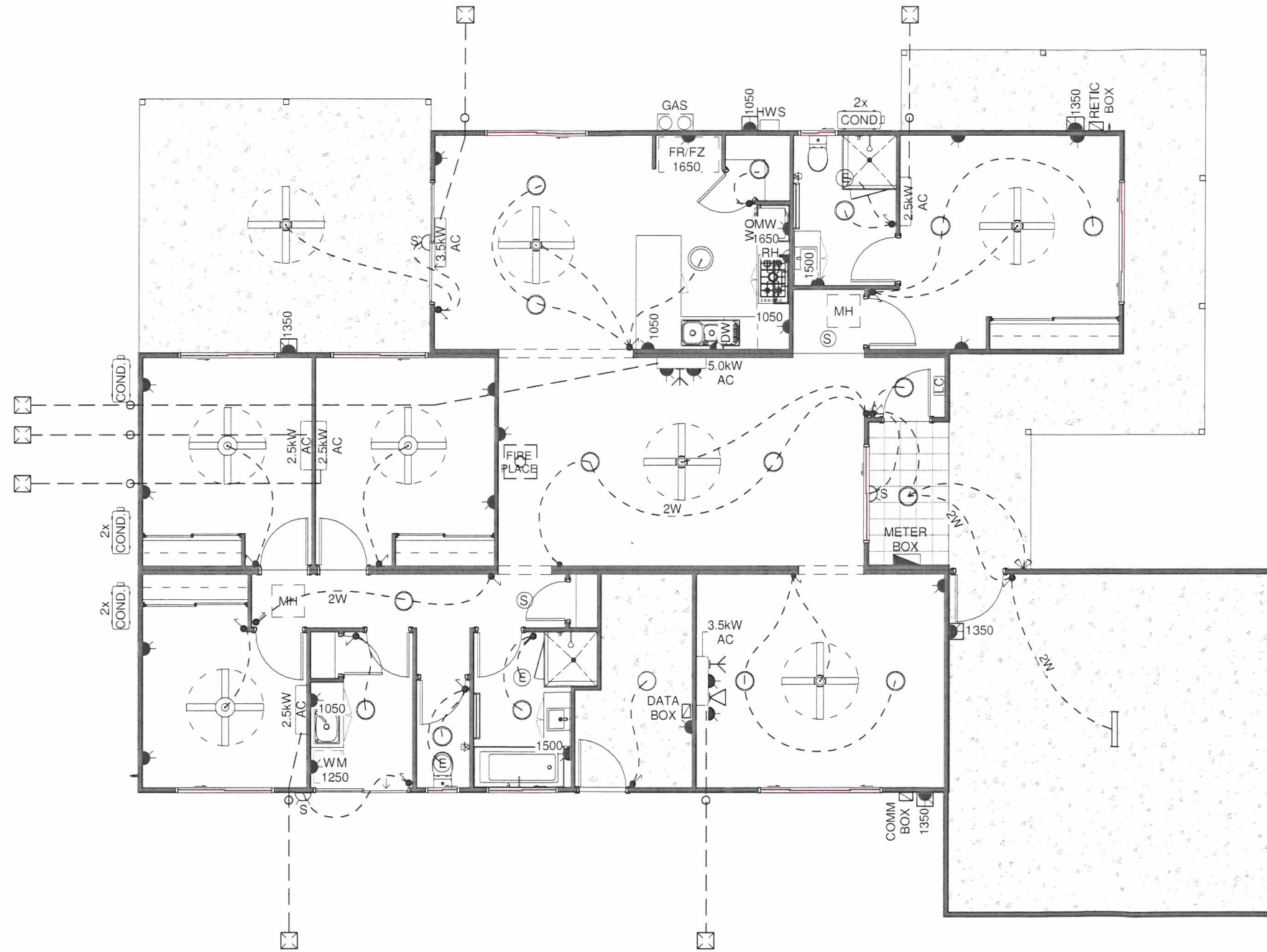

**1 ELECTRICAL PLAN**  
A04 1 : 100

## TENDER DRAWINGS

Copyright. This document is and shall remain the property of Quality Builders PTY LTD ©

**QUALITY BUILDERS**  
A Division Of Quality Builders  
PO Box 303, Kalamunda WA 6926  
(08) 9454 9522  
www.qualitybuilders.com.au

A	PREPARE TENDER DRAWINGS	RIR	21/10/2020
ISSUE	AMENDMENT	BY	DATE

SHEET CONTENT:		
<b>ELECTRICAL PLAN</b>		
DATE:	DRAWN BY:	CHECKED BY:
15/10/2020	RIR	JH
SCALE:	1 : 100	<b>A3</b>

PROPOSED RESIDENCE FOR		
<b>4 BED+ 2 BATH</b>		
<b>LOT 50 SMITH STREET, WICKEPIN WA 6370</b>		
PROJECT NO.	DWG. NO.	REV.
QBQ373	A04	A

O:\Drawing\2020\Quality Builders\QBQ373 - Wickepin House 4+2 Executive House.rvt

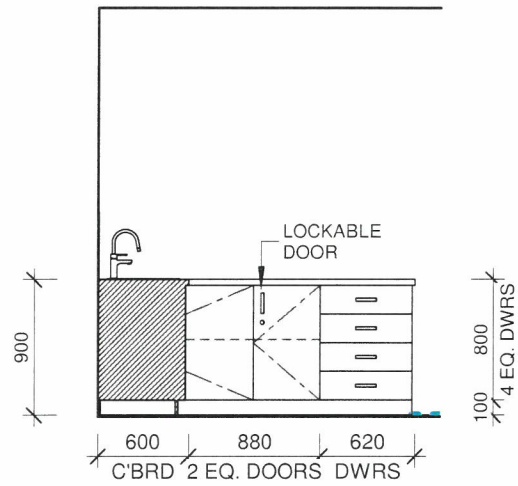
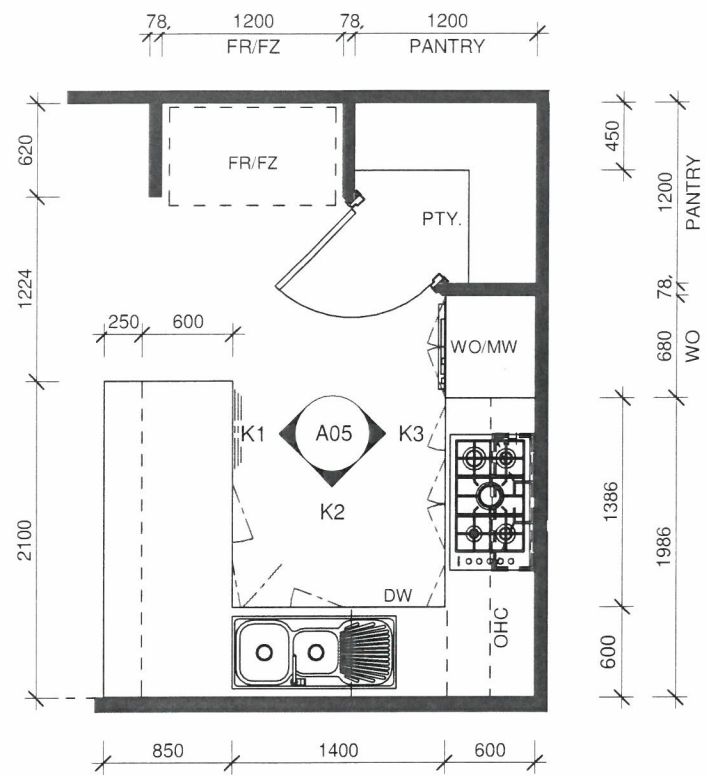

**K1** K1 ELEV  
A05 1:50

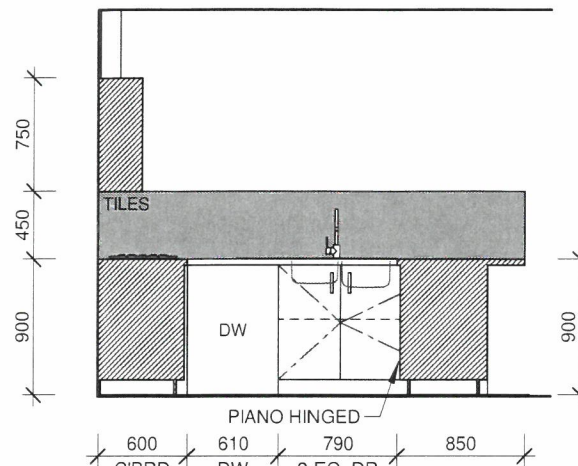

**K2** K2 ELEV  
A05 1:50

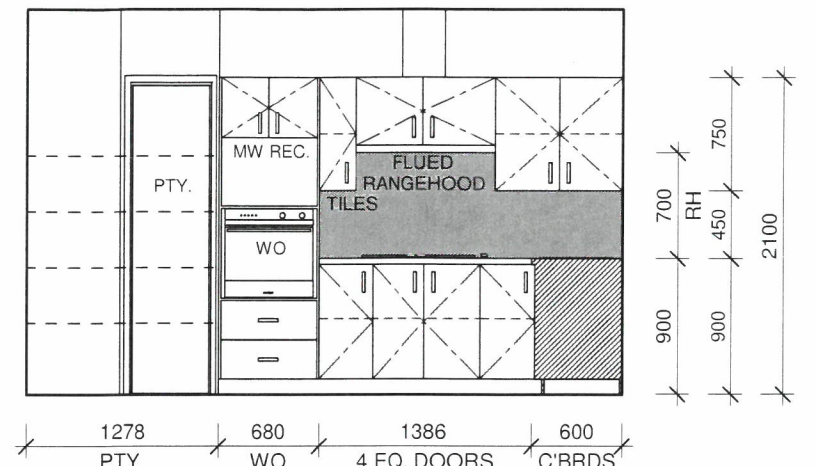

**K3** K3 ELEV  
A05 1:50

**K** KITCHEN LAYOUT  
A05 1:50

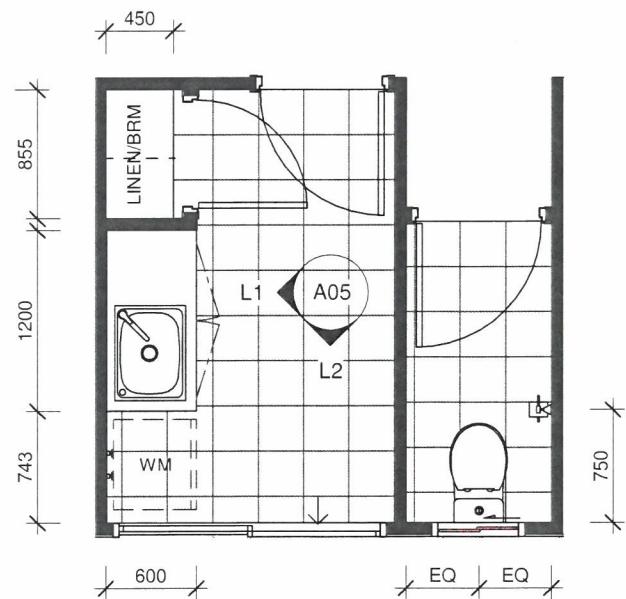

**LW** LAUNDRY & WC LAYOUT  
A05 1:50

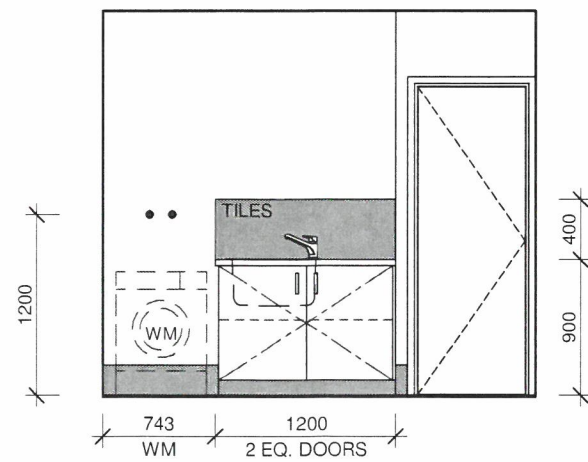

**L1** L1 ELEV  
A05 1:50

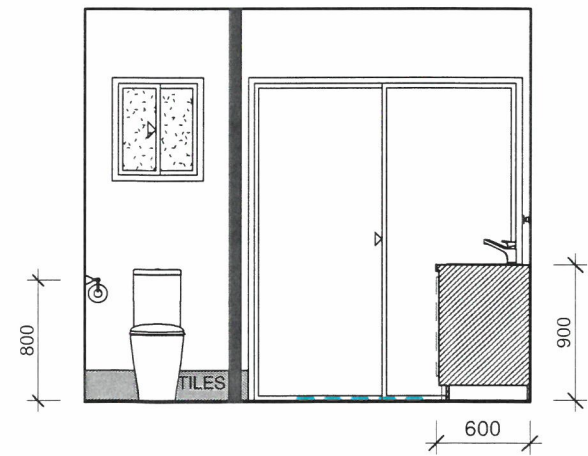

**L2** L2 ELEV  
A05 1:50

**TENDER DRAWINGS**

Copyright: This document is and shall remain the property of Quality Builders PTY LTD ©

**QUALITY BUILDERS**  
A Division Of Quality Builders  
PO Box 303, Kalamunda WA 6926  
(08) 9454 9522  
www.qualitybuilders.com.au

A	PREPARE TENDER DRAWINGS	RIR	21/10/2020
ISSUE	AMENDMENT	BY	DATE

SHEET CONTENT:  
**KITCHEN & LAUNDRY DETAILS**

DATE:	DRAWN BY:	CHECKED BY:
15/10/2020	RIR	JH
SCALE:	1:50	<b>A3</b>

PROPOSED RESIDENCE FOR  
**4 BED+ 2 BATH  
LOT 50 SMITH STREET,  
WICKEPIN WA 6370**

PROJECT NO.	DWG. NO.	REV.
QBQ373	A05	A

Q:\Drawings\2020\Quality Builders QBQ373 - Wickepin House 4+2 Executive QBQ373 - Wickepin 4+2 Executive House.rvt

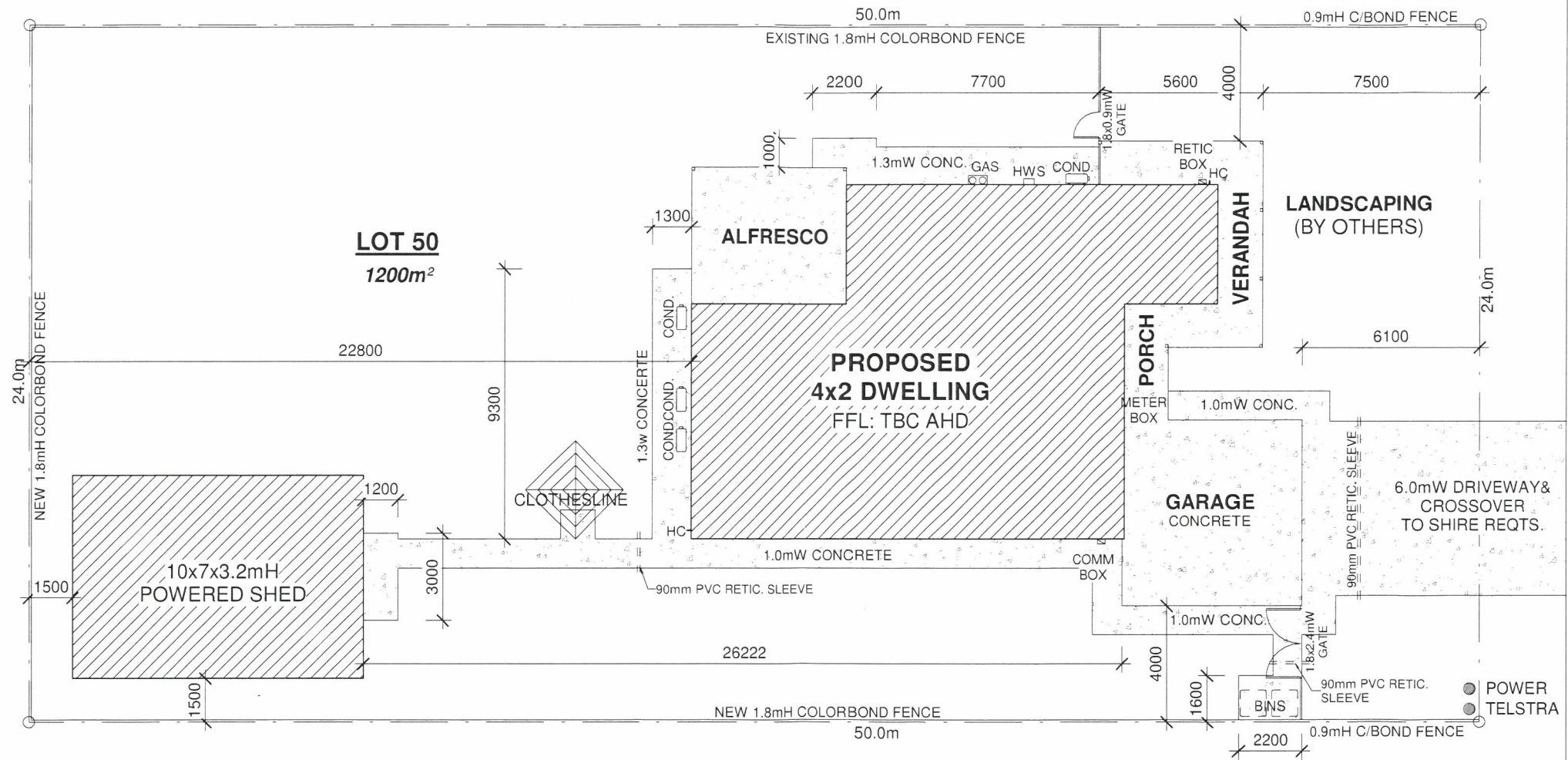
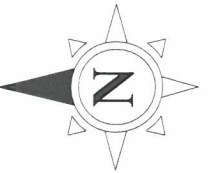

**SMITH STREET**

**NOTE:**  
DEEMED TO SATISFY NCC SUB FLOOR VENTILATION: SUSPENDED CONCRETE SLABS **PART 3.4.1**

**TENDER DRAWINGS**

Copyright. This document is and shall remain the property of Quality Builders PTY LTD ©

**QUALITY BUILDERS**  
A Division Of Quality Builders  
PO Box 303, Kalamunda WA 6926  
(08) 9454 9522  
[www.qualitybuilders.com.au](http://www.qualitybuilders.com.au)

A	PREPARE TENDER DRAWINGS	RIR	21/10/2020
ISSUE	AMENDMENT	BY	DATE

SHEET CONTENT:

**PROPOSED SITE PLAN**

DATE:	DRAWN BY:	CHECKED BY:
16/10/2020	RIR	JH
SCALE:	1 : 200	<b>A3</b>

PROPOSED RESIDENCE FOR

**4 BED+ 2 BATH**  
**LOT 50 SMITH STREET,**  
**WICKEPIN WA 6370**

PROJECT NO.	DWG. NO.	REV.
QBQ373	A08	A

O:\Drawings\2020\Quality Builders\QBQ373 - Wickepin House 4x2 Executive\QBQ373 - Wickepin 4x2 Executive House.rvt

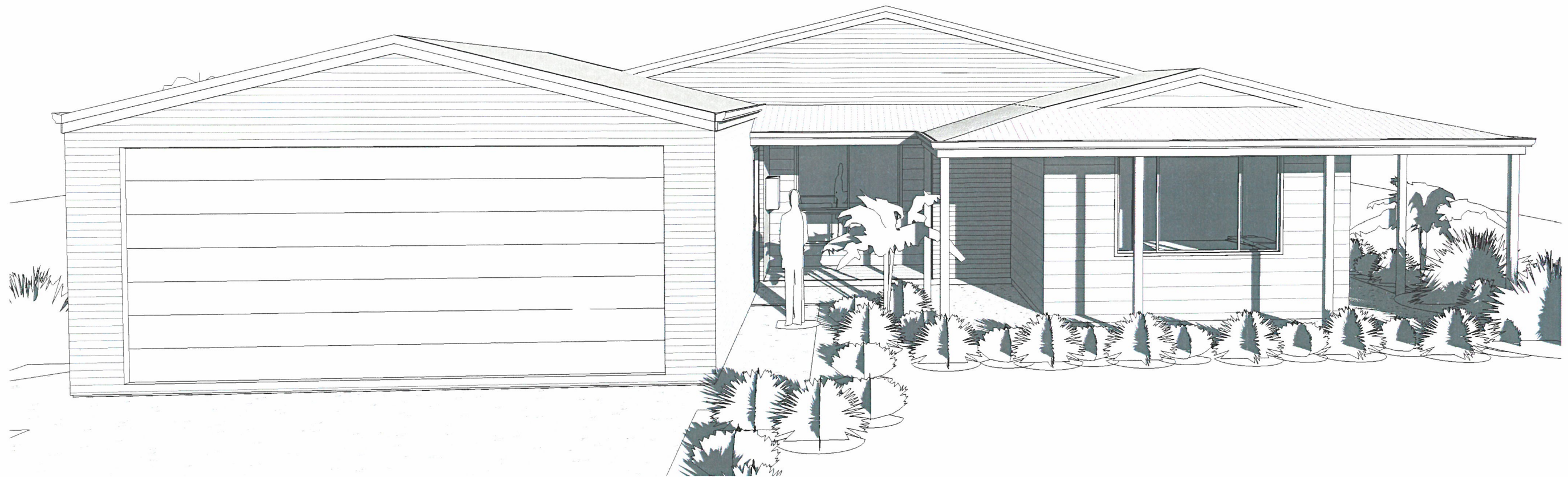

1 ARTIST'S PERSPECTIVE  
A00

**TENDER DRAWINGS**

Copyright. This document is and shall remain the property of Quality Builders PTY LTD ©

**QUALITY BUILDERS**  
A Division Of Quality Builders  
PO Box 303, Kalamunda WA 6926  
(08) 9454 9522  
[www.qualitybuilders.com.au](http://www.qualitybuilders.com.au)



ISSUE	AMENDMENT	RIR BY	DATE
A	PREPARE TENDER DRAWINGS	RIR	21/10/2020

SHEET CONTENT:		
<b>PERSPECTIVE</b>		
DATE:	DRAWN BY:	CHECKED BY:
25/09/2019	RIR	JH
SCALE:	<b>A3</b>	

PROPOSED RESIDENCE FOR		
4 BED+ 2 BATH LOT 50 SMITH STREET, WICKEPIN WA 6370		
PROJECT NO.	DWG. NO.	REV.
QBQ373	A00	A

O:\Drawings\2020\Quality Builders\Bulders\QBQ373 - Wickepin House 4x2 Executive\QBQ373 - Wickepin 4x2 Executive House.rvt